



Record of Survey - DP 587794

Survey Number DP 587794
Surveyor Reference 3590
Surveyor Steven James Green
Survey Firm Apex Surveying Ltd (Auckland)
Surveyor Declaration I Steven James Green, being a licensed cadastral surveyor, certify that--
(a) this dataset provided by me and its related survey are accurate, correct and in accordance with the Cadastral Survey Act 2002 and Cadastral Survey Rules 2021; and
(b) the survey was undertaken by me or under my personal direction.
Declared on 18 Apr 2023 04:26 PM

Survey Details

Dataset Description AREA 2 AND AREA G ON LOT 80 DP 13312
Purpose Flat plan/Cross-lease
Status Deposited **Type** Survey
Land District North Auckland **Survey Class** Class A
Meridional Circuit Mount Eden OCD **Vertical Datum** None

Survey Dates

Surveyed Date 07/02/2023 **Certified Date** 18/04/2023
Submitted Date 18/04/2023 16:26:18 **Survey Approval Date** 19/04/2023
Deposit Date 09/11/2023

Referenced Surveys

Survey Number	Land District	Bearing Correction
DP 13312	North Auckland	0°00'00"
DP 160802	North Auckland	0°00'00"
DP 161897	North Auckland	0°00'00"

Territorial Authorities

Auckland Council

Comprised In

RT NA97C/506
RT NA96C/745
RT NA96C/746

Created Parcels

Parcels	Parcel Intent	Area	RT Reference
Area 2 Deposited Plan 587794	Cross Lease Building		1116253
Area G Deposited Plan 587794	Covenant - Flat/Crosslease		
Total Area		<hr/> 0.0000 Ha	



**BOURNEMOUTH
TERRACE**

- NOTES:
- 1) Area marked (G) is to be subject to covenants
 - 2) Boundaries of areas to be leased are to outside faces of walls and structures unless otherwise shown.
 - 3) Unless otherwise shown covenant boundaries are not visibly defined.
 - 4) Covenant boundaries follow outside faces of walls and structures at ground level.
 - 5) External boundaries adopted from DP 13312.
 - 6) Permanent structure boundaries defining Area G adopted from DP 161897.

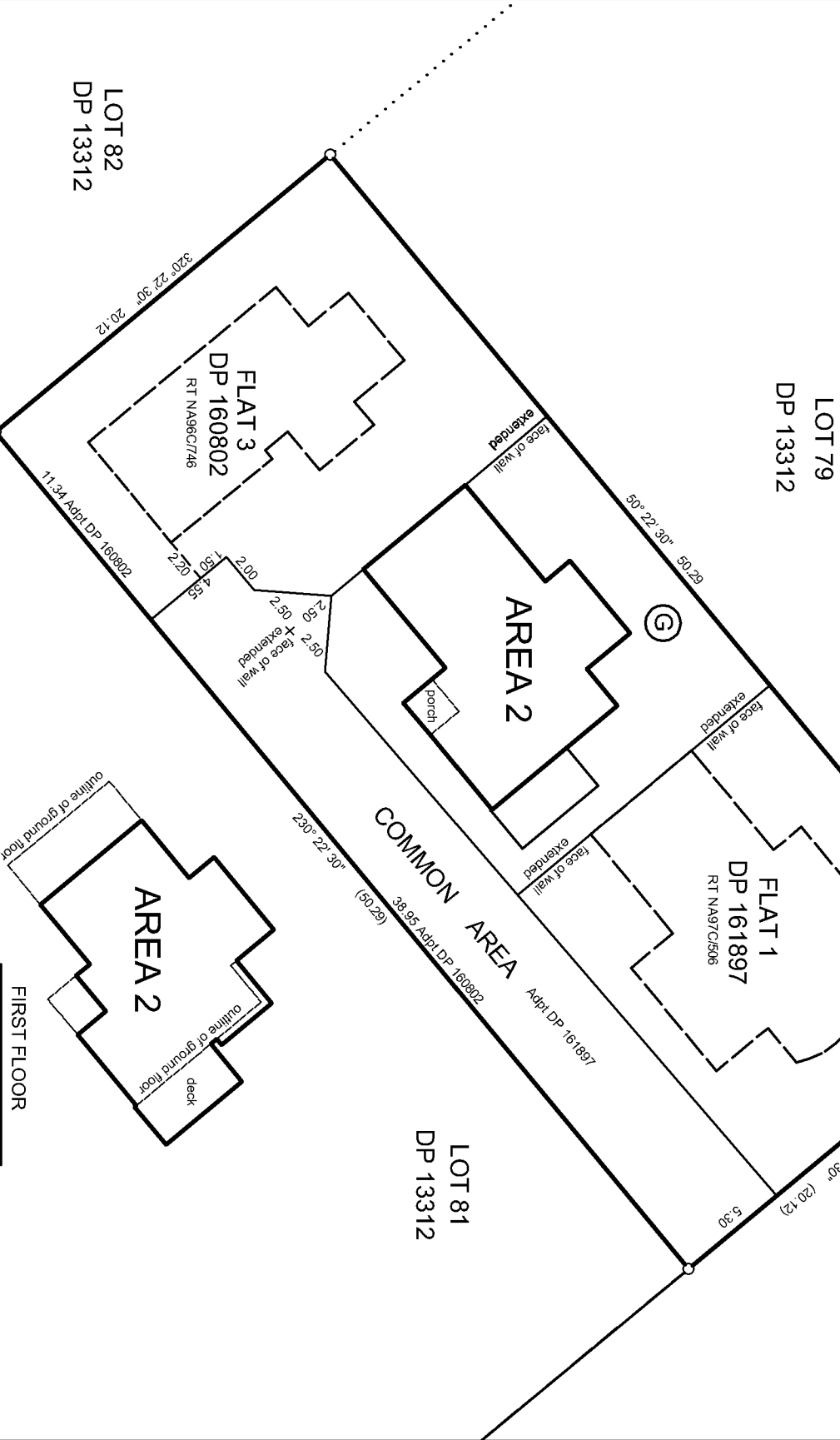

LAND DISTRICT: North Auckland
 TERRITORIAL AUTHORITY: Auckland Council

AREA 2 AND AREA G ON LOT 80 DP 13312

Date: February 2023
 Surveyed by: **Apex** Surveying Ltd
 Scale: Proportional

Surveyor: Steven James Green
 Our Ref: 3590

DP 587794

Survey Class: Class A
Total Area: 1012m ²
Comprised in: RT NA97C/506 RT NA96C/745 RT NA96C/746
SUPPORTING DOCUMENT PLAN GRAPHIC