



# Record of Survey - DP 586120

---

**Survey Number** DP 586120  
**Surveyor Reference** 3799 - 339 Riverside Drive - Baldock  
**Surveyor** Stuart David Watson  
**Survey Firm** Valley Surveying Company Ltd (Lower Hutt)  
**Surveyor Declaration** I Stuart David Watson, being a licensed cadastral surveyor, certify that--  
(a) this dataset provided by me and its related survey are accurate, correct and in accordance with the Cadastral Survey Act 2002 and Cadastral Survey Rules 2021; and  
(b) the survey was undertaken by me or under my personal direction.  
Declared on 01 Sep 2023 02:14 PM

---

## Survey Details

**Dataset Description** Areas 1 & 2 on Lot 19 DP 9155  
**Purpose** Flat plan/Cross-lease  
**Status** Deposited **Type** Survey  
**Land District** Wellington **Survey Class** Class A  
**Meridional Circuit** Wellington OCD **Vertical Datum** None

---

## Survey Dates

**Surveyed Date** 20/12/2022 **Certified Date** 01/09/2023  
**Submitted Date** 01/09/2023 14:14:36 **Survey Approval Date** 04/09/2023  
**Deposit Date** 01/08/2023

---

## Referenced Surveys

| Survey Number | Land District | Bearing Correction |
|---------------|---------------|--------------------|
| DP 9155       | Wellington    | 0°00'00"           |
| DP 56405      | Wellington    | 0°00'00"           |
| DP 56407      | Wellington    | 0°00'00"           |

---

## Territorial Authorities

Hutt City

---

## Comprised In

RT WN27B/258  
RT WN54C/159

---

## Created Parcels

| Parcels                      | Parcel Intent                 | Area | RT Reference |
|------------------------------|-------------------------------|------|--------------|
| Area 1 Deposited Plan 586120 | Cross Lease Building          |      | 1127218      |
| Area 2 Deposited Plan 586120 | Cross Lease Building          |      | 1127219      |
| Area B Deposited Plan 586120 | Covenant -<br>Flat/Crosslease |      |              |
| Area D Deposited Plan 586120 | Covenant -<br>Flat/Crosslease |      |              |
| Area E Deposited Plan 586120 | Covenant -<br>Flat/Crosslease |      |              |



# Record of Survey - DP 586120

---

## Created Parcels

| Parcels                      | Parcel Intent                 | Area            | RT Reference |
|------------------------------|-------------------------------|-----------------|--------------|
| Area F Deposited Plan 586120 | Covenant -<br>Flat/Crosslease |                 |              |
| Area G Deposited Plan 586120 | Covenant -<br>Flat/Crosslease |                 |              |
| Area H Deposited Plan 586120 | Covenant -<br>Flat/Crosslease |                 |              |
| Area I Deposited Plan 586120 | Covenant -<br>Flat/Crosslease |                 |              |
| Area J Deposited Plan 586120 | Covenant -<br>Flat/Crosslease |                 |              |
| Area K Deposited Plan 586120 | Covenant -<br>Flat/Crosslease |                 |              |
| Area L Deposited Plan 586120 | Covenant -<br>Flat/Crosslease |                 |              |
| Area M Deposited Plan 586120 | Covenant -<br>Flat/Crosslease |                 |              |
| <b>Total Area</b>            |                               | <hr/> 0.0000 Ha |              |

Lot 56  
DP 8245

Lot 2  
DP 87416

Lot 3  
DP 30396



284°35'  
29.22

284°35'  
3.08

284°35'  
2.20

12°21'  
3.69

12°26'  
3.55

44°59'  
4.11

3.07  
282°12'



garden shed

Subject to Part IV A  
Conservation Act 1987

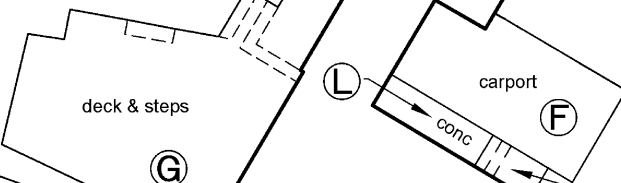

deck & steps

carport

Area 2

Area 1

covenant boundary  
centerline of wooden  
board fence to  
intersect underlying  
parcel boundary and  
lease boundary

lease boundary centerline  
of common interior wall

covenant boundary  
centerline of wooden  
board fence to  
intersect underlying  
parcel boundary and  
lease boundary

194°35'00"  
(45.72)

0.66  
clear

Lot 18  
DP 9155



garden shed

0.63  
clear

44°59'00"  
41.26

Lot 19  
DP 9155  
WN27B/258  
WN54C/159

steps & porch



13.92 Arc  
13.38 Radius

NOTES:

1. Underlying parcel boundaries adopted from DP 9155 & DP 56407 in terms of Wellington OCD.
2. Areas B, D, E, F, G, H, I, J, K, L & M are to be subject to restrictive covenants.
3. Lease and Covenant boundaries are coincident with the outside face of buildings porches, steps and decks unless otherwise shown.
4. Covenant Areas H & I boundaries are adopted from DP 56407.
5. Area L boundaries coincident with Area 2, F & K boundaries

DC edit 24/08/23

AREAS 1 & 2 ON LOT 19 DP 9155



Licensed Surveyors, Resource Management  
and Land Development Consultants  
Level 1, 46 Victoria Street, Alicetown  
PO Box 30-686, Lower Hutt  
Tel: (04) 586-8863  
Email: admin@valleysurveying.co.nz

Copyright of this drawing is vested in Valley Surveying Company Ltd.

LAND DISTRICT  
WELLINGTON  
HUTT CITY COUNCIL  
SURVEYOR  
STU WATSON

SCALE  
1:150 @A3  
DATE  
19 DEC 2022  
PLAN No  
VSC 3799-03

PLAN GRAPHIC  
**DP 586120**  
SHEET 1 IN A SERIES OF 1 SHEETS