



CSD Plan - DP 538206/A

Survey Number DP 538206/A
Surveyor Reference 6479 Barrack Rd PUD
Surveyor Rogan Hampson
Survey Firm Hampson & Associates Ltd
Surveyor Declaration I Rogan Hampson, being a licensed cadastral surveyor, certify that:
(a) this dataset provided by me and its related survey are accurate, correct and in accordance with the Cadastral Survey Act 2002 and the Rules for Cadastral Survey 2010, and
(b) the survey was undertaken by me or under my personal direction.
Declared on 09 Dec 2021 02:39 PM

Survey Details

Dataset Description Proposed Unit Development on Lot 8 DP 480614
Purpose Proposed Unit Development
Status Deposited **Type** Survey
Land District North Auckland **Survey Class** Class A
Meridional Circuit Mount Eden 2000 **Vertical Datum** None

Survey Dates

Surveyed Date 05/02/2021 **Certified Date** 09/12/2021
Submitted Date 09/12/2021 14:39:29 **Survey Approval Date** 10/12/2021
Deposit Date 08/07/2022

Referenced Surveys

Survey Number	Land District	Bearing Correction
DP 480614	North Auckland	0°00'00"

Territorial Authorities

Auckland Council

Comprised In

RT 671991



SITE PLAN BIRD'S EYE VIEW

DP 480614

23'52" 48.49

SHEET 1/12

LAND DISTRICT NORTH AUCKLAND
 DATASET TYPE SURVEYED
 DATUM GEODETIC 2000

PROPOSED UNIT DEVELOPMENT
 ON LOT 8 DP 480614

TERRITORIAL AUTHORITY Auckland Council
 Surveyed by HAMPSON & ASSOCIATES LTD
 Scale 1:500 Date October 2021

Comprised in 67/1991
 File 64/79
 DP 5382061A

NOTES:
 UNLESS SHOWN OTHERWISE:
 1. PRINCIPAL UNIT BOUNDARIES (PUS) ARE TO THE CENTRE LINE OF WALLS, GLAZING, HANDRAILS OR STRUCTURES. PARKING PU (SUFFIXED P) BOUNDARIES ARE EQUIDISTANT BETWEEN COLUMNS, THE INTERNAL FACE OF CONCRETE WALLS OR THE CENTRE LINE OF THE STORAGE UNIT WALLS.
 2. THE UPPER AND LOWER LIMITS OF PU'S ARE TO THE CENTRE OF THE CONCRETE FLOOR SLABS.
 3. THE UPPER LIMITS OF TOP FLOOR PU'S ARE TO THE UNDERSIDE OF THE SUSPENDED CEILING.
 4. UPPER AND LOWER PRINCIPAL UNIT BOUNDARIES ON PARKING UNITS (SUFFIXED P) ARE TO THE UPPER FINISHED SURFACE OF THE CONCRETE FLOOR SLAB AND 2.20m ABOVE THE UPPER FINISHED SURFACE OF THE CONCRETE FLOOR SLAB.
 5. UPPER AND LOWER PRINCIPAL UNIT BOUNDARIES ON EXTERIOR PARKING UNITS (SUFFIXED P) ARE TO THE UPPER FINISHED SURFACE OF THE SEALED PARKING AREAS AND 2.20m ABOVE THE UPPER FINISHED SURFACE OF THE SEALED PARKING AREAS
 6. STORAGE PRINCIPAL UNIT BOUNDARIES (SUFFIXED S) ARE TO THE EXTERNAL FACE OF THE STEEL STRUCTURE OR THE CENTRELINE OF THE WALLS IF ADJACENT TO A PARKING UNIT.
 7. AREAS A & V ARE COMMON PROPERTY.

3
DP 315665

2
DP 336425

15
DP 32230

14
DP 32230

11
DP 32230

10
DP 32230

COMMON PROPERTY

COMMON PROPERTY

COMMON PROPERTY

COMMON PROPERTY

COMMON PROPERTY

COMMON PROPERTY

Pt 7
DP 32230

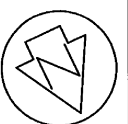

BASEMENT FLOOR PLAN

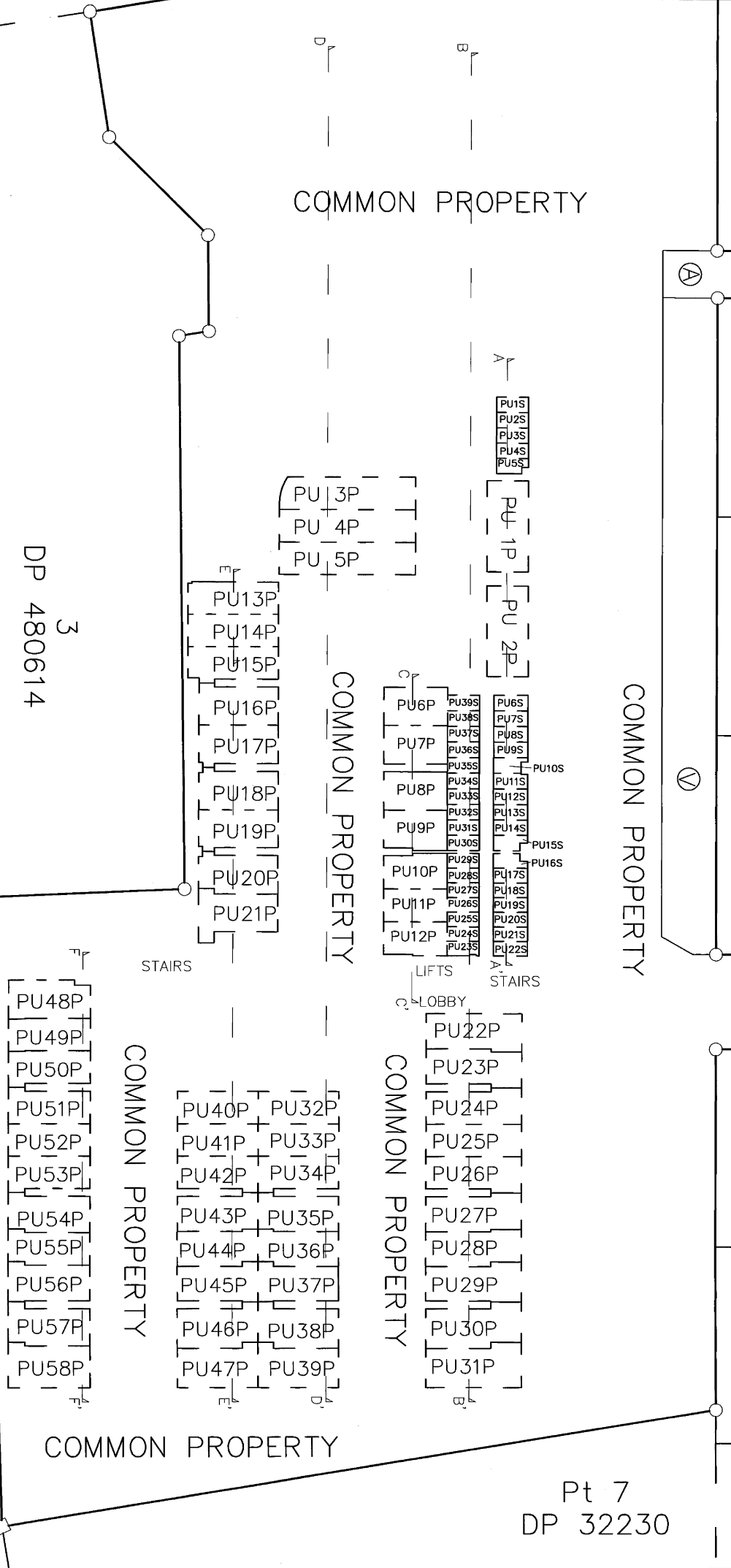

LAND DISTRICT NORTH AUCKLAND
DATASET TYPE SURVEYED
DATUM GEODETIC 2000

PROPOSED UNIT DEVELOPMENT
ON LOT 8 DP 480614

TERRITORIAL AUTHORITY Auckland Council
Surveyed by HAMPSON & ASSOCIATES LTD
Scale 1:300 Date October 2021

Comprised in 671991
File 6479
Received Instructions

SHEET 2/12
DP 538206/A

3
DP 315665

2
DP 336425

15
DP 32230

14
DP 32230

11
DP 32230

10
DP 32230



PU109P
PU110P
PU111P
PU112P
PU113P
PU114P
PU115P
PU116P
PU117P
PU118P
PU119P
PU120P
PU121P
PU122P
PU123P

TRANS-FORMER

COMMON PROPERTY

PU40S

PU126P
PU125P
PU124P

Pt 7
DP 32230

courtyard
B

PU 1G

balcony
balcony

PU 3G

LIFTS
ducts

PU 5G

planter
balcony

PU 6G

planter
balcony

PU 7G

balcony

RUBBISH ROOM

PU40S

PU41S
PU42S
PU43S
PU44S
PU45S
PU46S

LIFTS
STAIRS

LOBBY

PU72P
PU73P

PU74P
PU75P

PU76P
PU77P

PU78P
PU79P

PU80P
PU81P

courtyard
D

PU 2G

balcony
balcony

PU 4G

STAIRS
ducts

PU 5G

balcony

PU 6G

balcony

PU 7G

duct

COMMON PROPERTY

PU59P
PU60P
PU61P
PU62P
PU63P
PU64P
PU65P

COMMON PROPERTY

STAIRS

COMMON PROPERTY

PU90P
PU91P
PU92P
PU93P
PU94P
PU95P
PU96P
PU97P

PU82P
PU83P
PU84P
PU85P
PU86P
PU87P
PU88P
PU89P

COMMON PROPERTY

COMMON PROPERTY

COMMON PROPERTY

COMMON PROPERTY

courtyard

PU 2G

balcony

PU 4G

balcony

PU 5G

balcony

PU 6G

balcony

PU 7G

PU66P
PU67P
PU68P
PU69P
PU70P
PU71P

COMMON PROPERTY

COMMON PROPERTY

COMMON PROPERTY

COMMON PROPERTY

COMMON PROPERTY

COMMON PROPERTY

COMMON PROPERTY

COMMON PROPERTY

COMMON PROPERTY

COMMON PROPERTY

COMMON PROPERTY

COMMON PROPERTY

COMMON PROPERTY

3
DP 480614

GROUND FLOOR PLAN

SHEET 3/12

LAND DISTRICT NORTH AUCKLAND
DATASET TYPE SURVEYED
DATUM GEODETIC 2000

PROPOSED UNIT DEVELOPMENT
ON LOT 8 DP 480614

TERRITORIAL AUTHORITY Auckland Council
Surveyed by HAMPSON & ASSOCIATES LTD
Scale 1:300 Date October 2021

Comprised in 671991
File 6479
Received Instructions

DP 538206/A

3
DP 315665

2
DP 336425

15
DP 32230

14
DP 32230

11
DP 32230

10
DP 32230

Pt 7
DP 32230

COMMON PROPERTY

FIRST FLOOR PLAN

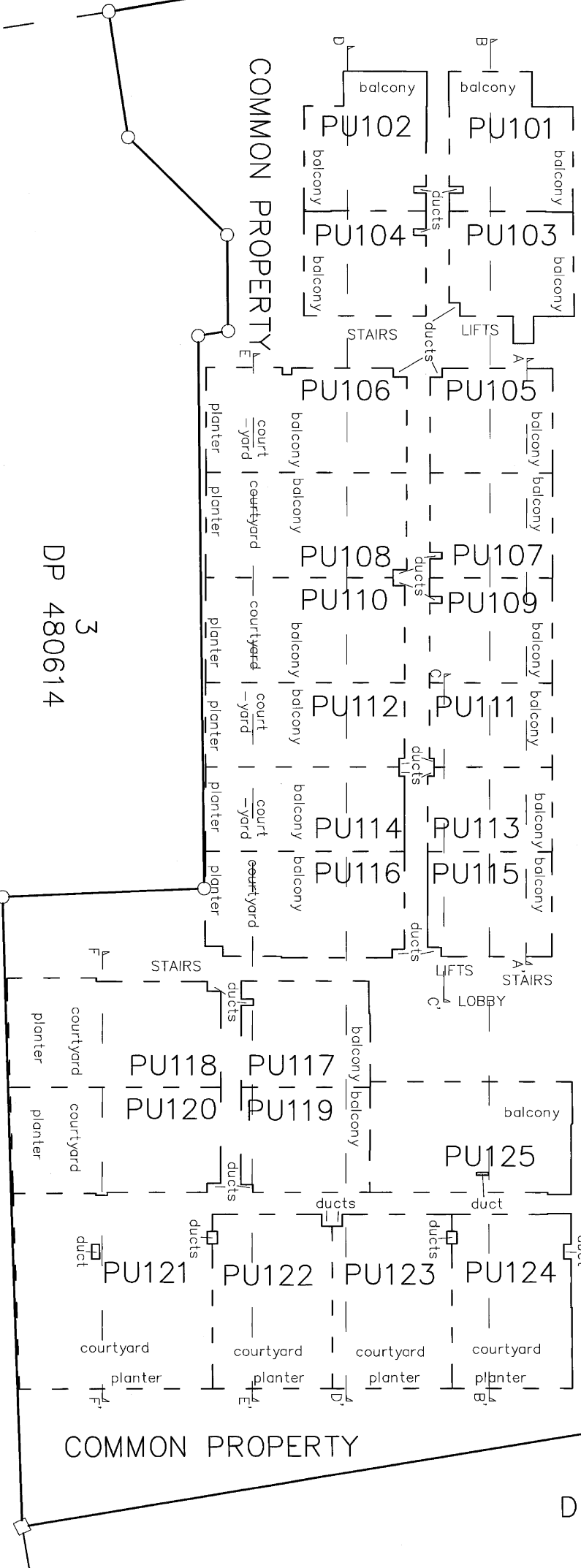

LAND DISTRICT NORTH AUCKLAND
 DATASET TYPE SURVEYED
 DATUM GEODETIC 2000

PROPOSED UNIT DEVELOPMENT
 ON LOT 8 DP 480614

TERRITORIAL AUTHORITY Auckland Council
 Surveyed by HAMPSON & ASSOCIATES LTD
 Scale 1:300 Date October 2021

Comprised in 671991
 File 6479
 Received Instructions

DP 538206/A

SHEET 4/12

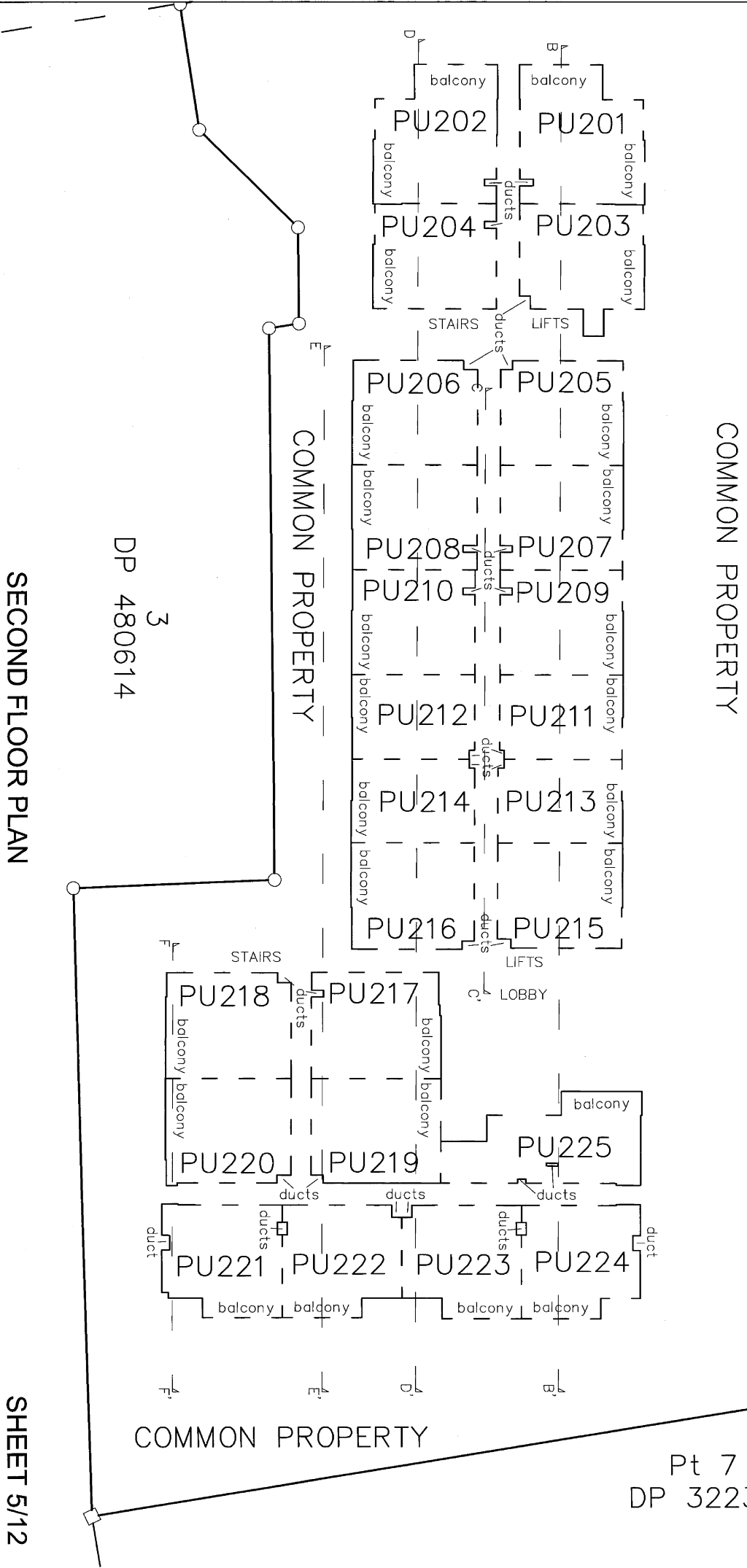
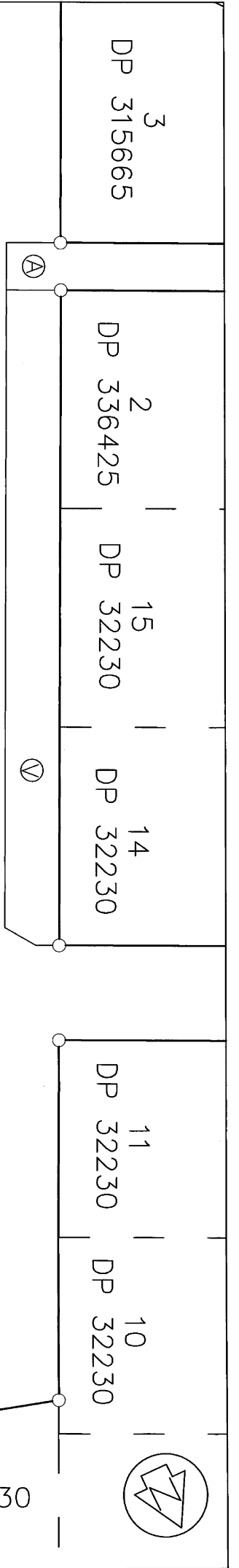

LAND DISTRICT: NORTH AUCKLAND
 DATASET TYPE: SURVEYED
 DATUM: GEODETIC 2000

PROPOSED UNIT DEVELOPMENT
 ON LOT 8 DP 480614

TERRITORIAL AUTHORITY: Auckland Council
 Surveyed by: HAMPSON & ASSOCIATES LTD
 Scale: 1:300
 Date: October 2021

Comprised in: 67/1991
 File: 6479
 Received Instructions

SECOND FLOOR PLAN

SHEET 5/12

DP 480614 3

DP 538206/A

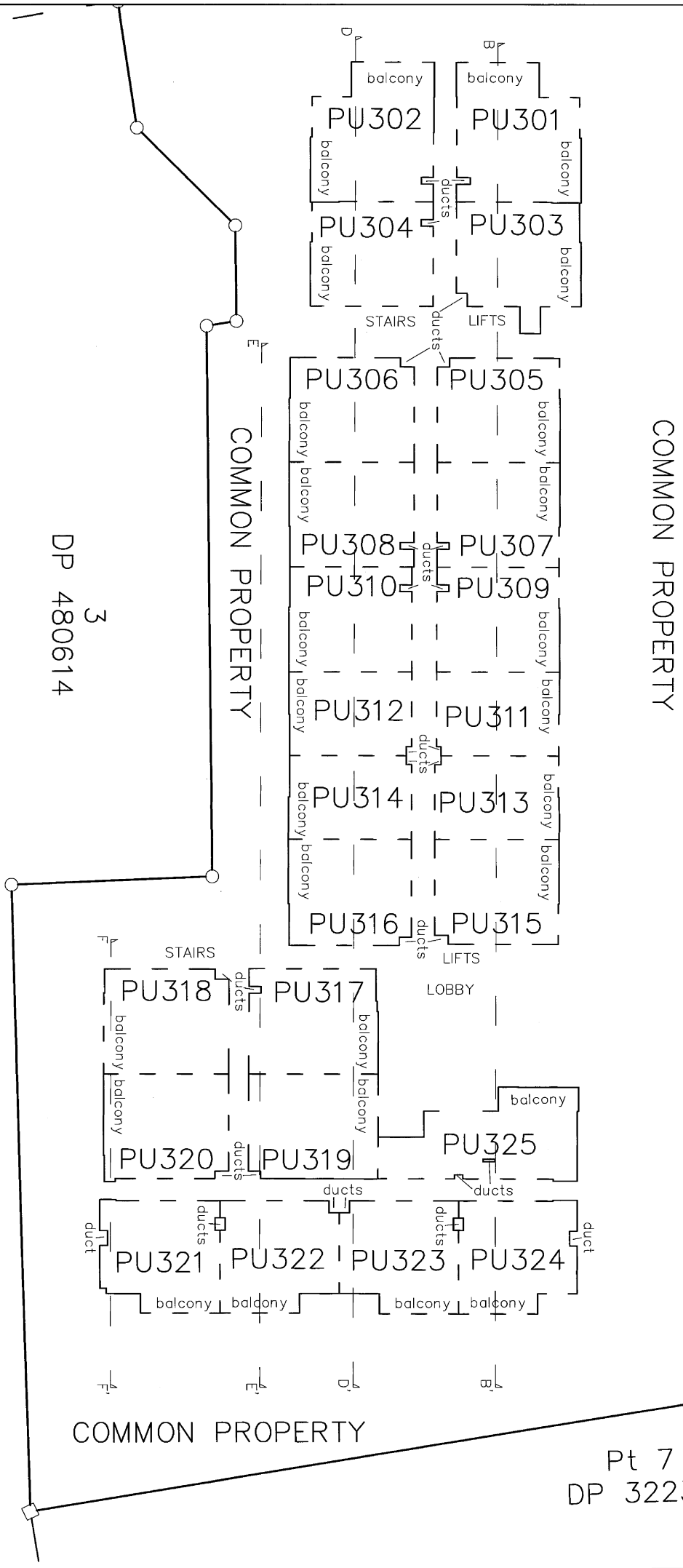
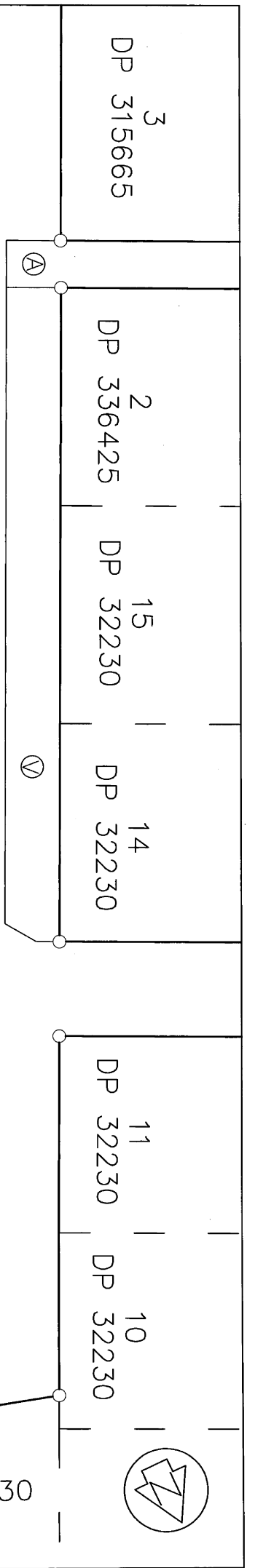

THIRD FLOOR PLAN

SHEET 6/12

LAND DISTRICT
 DATASET TYPE
 DATUM

NORTH AUCKLAND
 SURVEYED
 GEODETIC 2000

PROPOSED UNIT DEVELOPMENT
 ON LOT 8 DP 480614

TERRITORIAL AUTHORITY Auckland Council
 Surveyed by HAMPSON & ASSOCIATES LTD
 Scale 1:300 Date October 2021

Comprised in 671991
 File Received 6479
 Instructions DP 538206/A

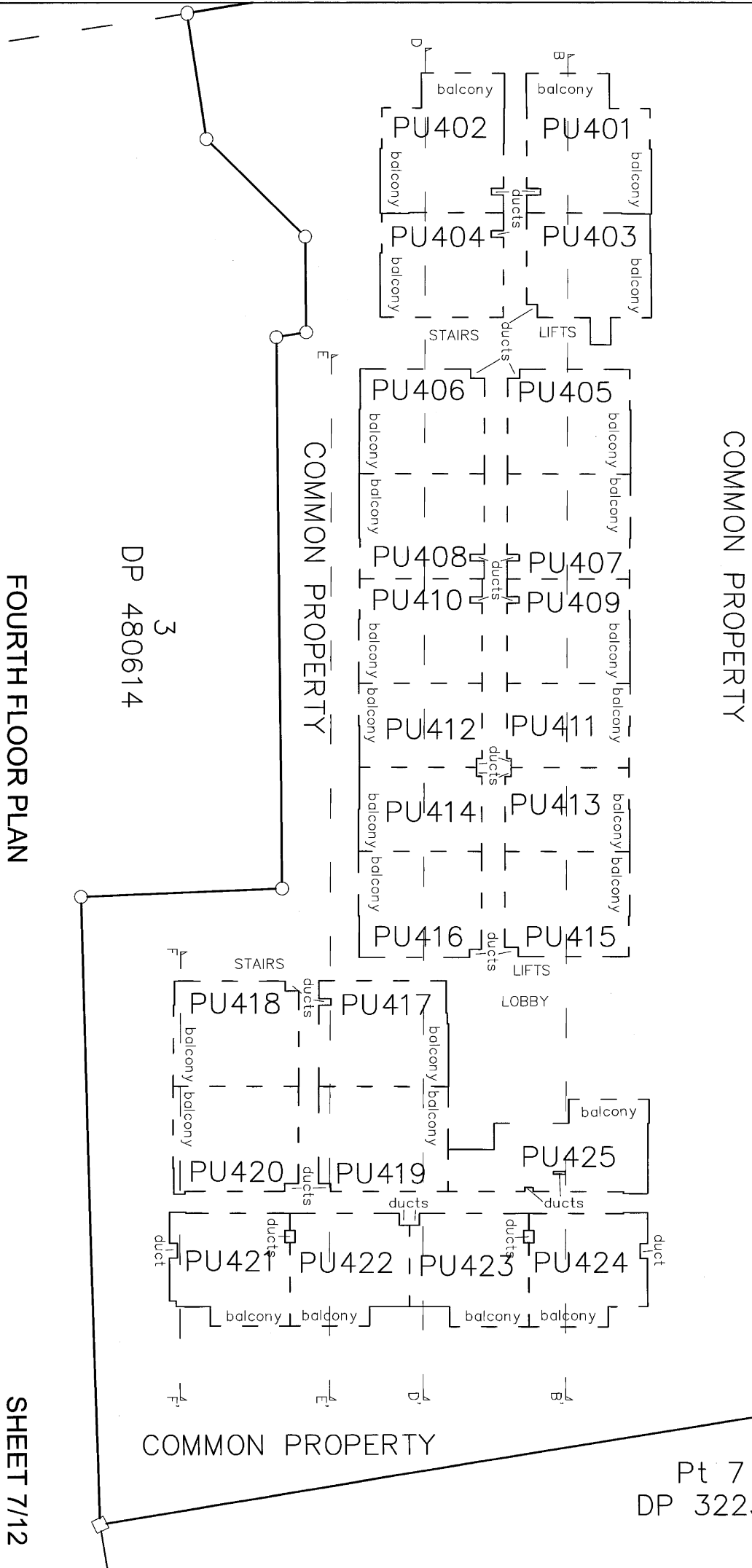
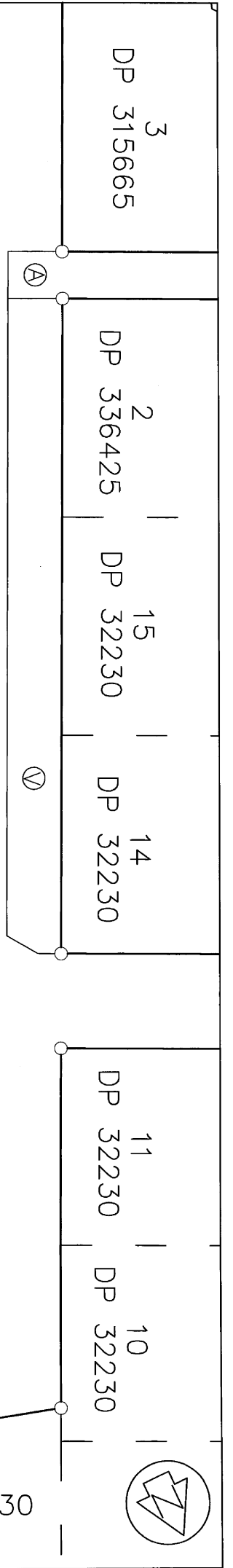

FOURTH FLOOR PLAN

SHEET 7/12

LAND DISTRICT NORTH AUCKLAND
 DATASET TYPE SURVEYED
 DATUM GEODETIC 2000

PROPOSED UNIT DEVELOPMENT
 ON LOT 8 DP 480614

TERRITORIAL AUTHORITY Auckland Council
 Surveved by HAMPSON & ASSOCIATES LTD
 Scale 1:300 Date October 2021

Comprised in 671991
 File 6479
 Received Instructions

DP 538206/A

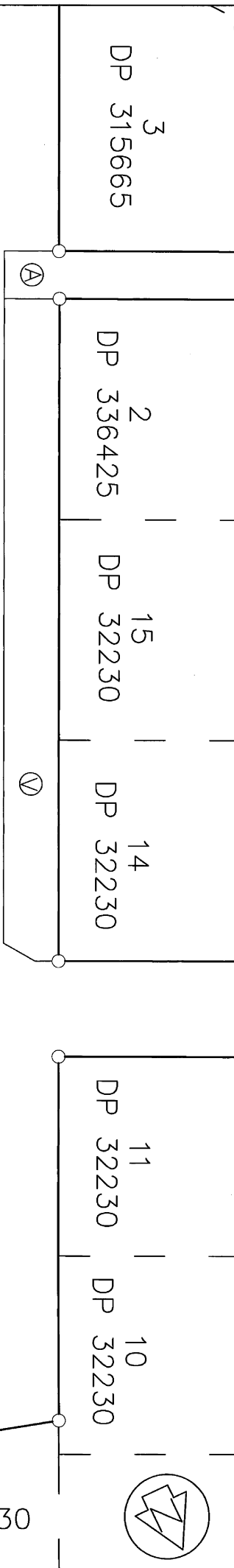

COMMON PROPERTY

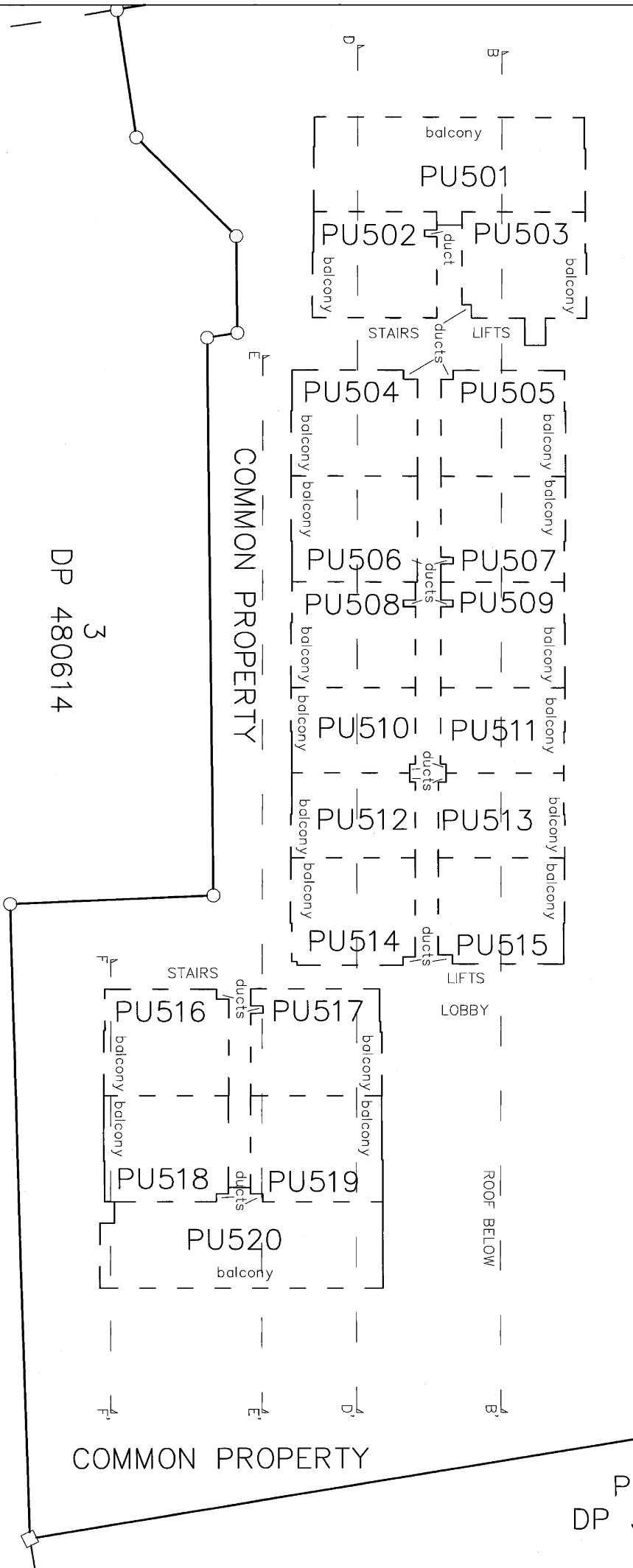

COMMON PROPERTY

COMMON PROPERTY

Pt 7
DP 32230

FIFTH FLOOR PLAN

SHEET 8/12

LAND DISTRICT NORTH AUCKLAND
 DATASET TYPE SURVEYED
 DATUM GEODETIC 2000

PROPOSED UNIT DEVELOPMENT
 ON LOT 8 DP 480614

TERRITORIAL AUTHORITY Auckland Council
 Surveyed by HAMPSON & ASSOCIATES LTD
 Scale 1:300 Date October 2021

Comprised in 671991
 File Received 6479
 Instructions

DP 538206/A

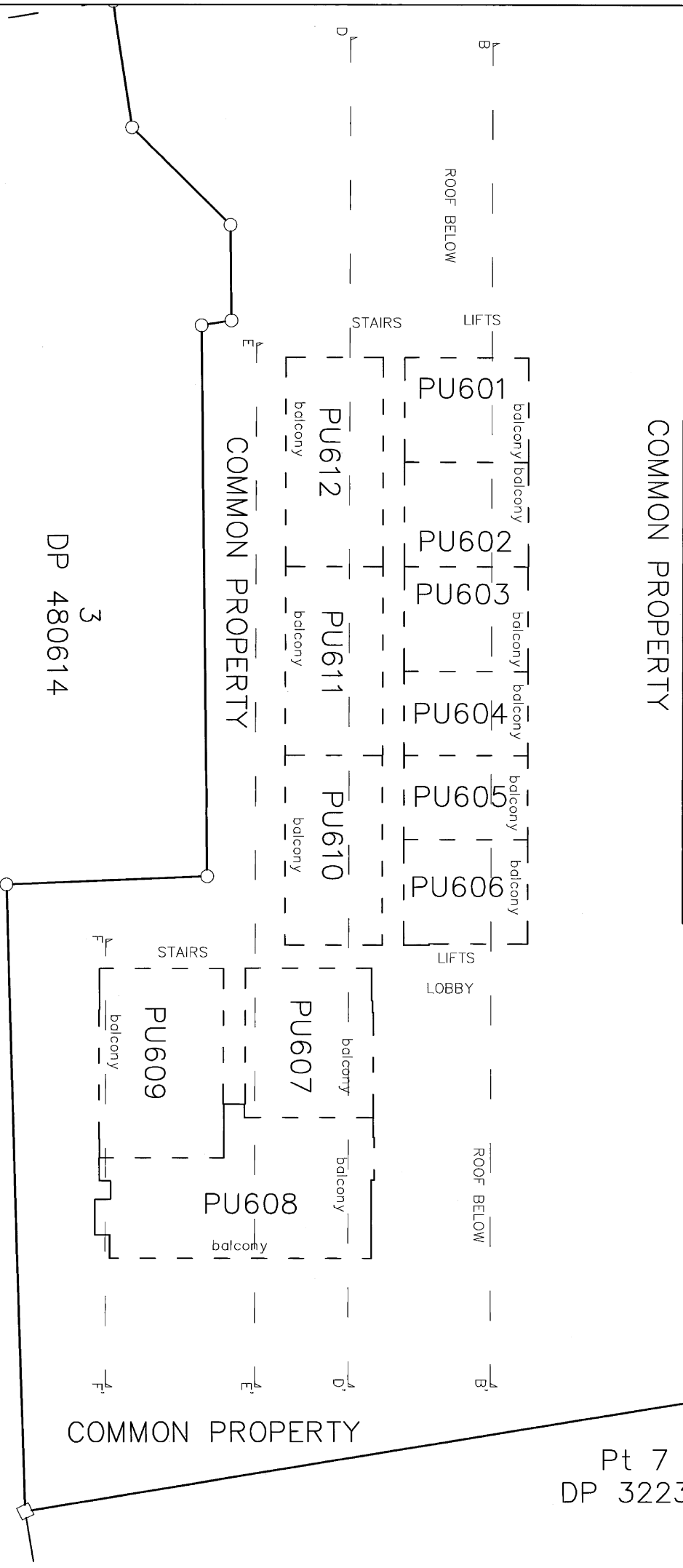
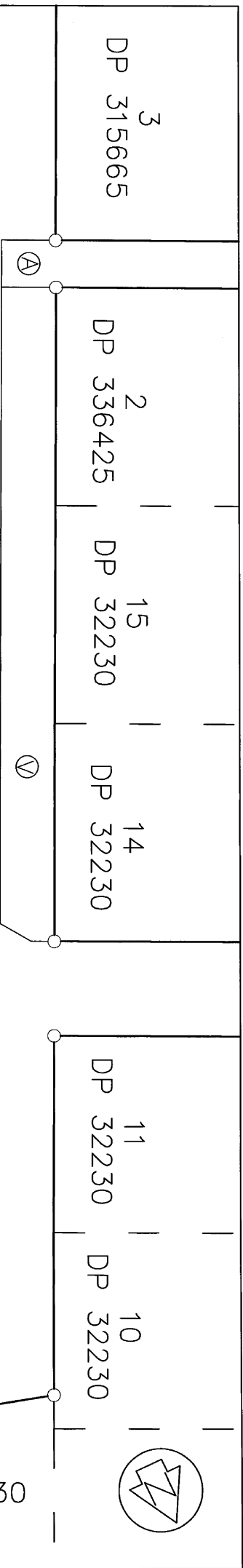

SIXTH FLOOR PLAN

SHEET 9/12

DP 480614

LAND DISTRICT
DATASET TYPE
DATUM

NORTH AUCKLAND
SURVEYED
GEODETIC: 2000

PROPOSED UNIT DEVELOPMENT
ON LOT 8 DP 480614

TERRITORIAL AUTHORITY Auckland Council
Surveyed by HAMPSON & ASSOCIATES LTD
Scale 1:300
Date October 2021

Comprised in 67/1991

File Received 6479 Instructions

DP 538206/A

COMMON PROPERTY

[PU105] [PU107] [PU109] [PU111] [PU113] [PU115]
 FIRST FLOOR

COMMON PROPERTY

[PU40S]
 [PU41S]
 [PU42S]
 [PU43S]
 [PU44S]
 [PU45S]
 [PU46S]

GROUND FLOOR

[1S] [2S] [3S] [4S] [5S] [6S] [7S] [8S] [9S] [10S] [11S] [12S] [13S] [14S] [15S] [16S] [17S] [18S] [19S] [20S] [21S] [22S]
 [PU 1P] [PU 2P]
 BASEMENT FLOOR

COMMON PROPERTY

SECTION A--A'

COMMON PROPERTY

[PU 111] [PU 113] [PU 115]
 FIRST FLOOR

[59P] [60P] [61P] [62P] [63P] [64P] [65P]
 GROUND FLOOR

[6E] [7P] [8E] [9P] [10P] [11P] [12E]
 BASEMENT FLOOR

COMMON PROPERTY

SECTION C--C'

LAND DISTRICT NORTH AUCKLAND	PROPOSED UNIT DEVELOPMENT ON LOT 8 DP 480614	TERRITORIAL AUTHORITY Auckland Council	Comprising in 67/1991
DATASET TYPE SURVEYED		Scale 1:200	File Received 6479
DATUM GEODETTIC 2000		Date October 2021	Instructions
			DP 538206/A

COMMON PROPERTY

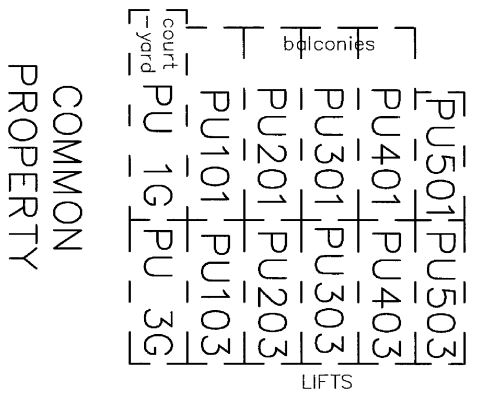

SECTION B-B'

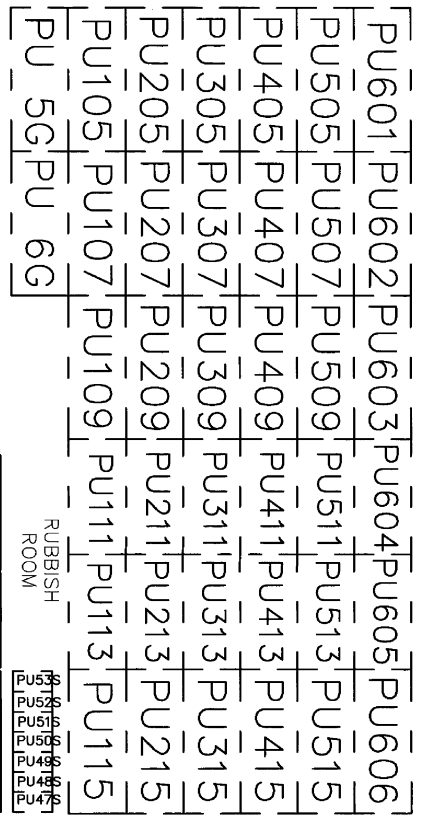
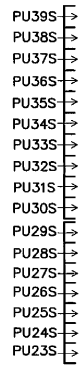

COMMON PROPERTY

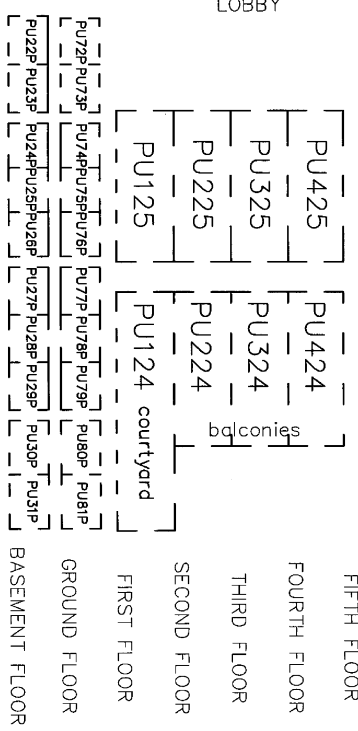

COMMON PROPERTY

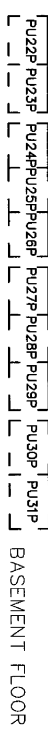

COMMON PROPERTY

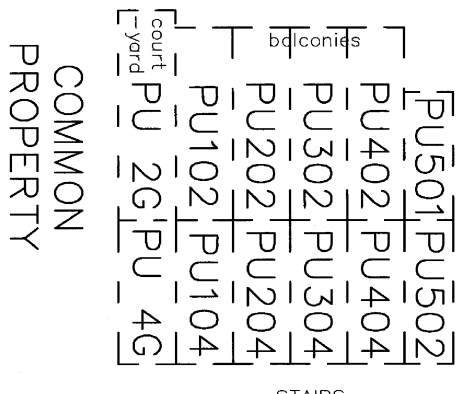

SECTION D-D'

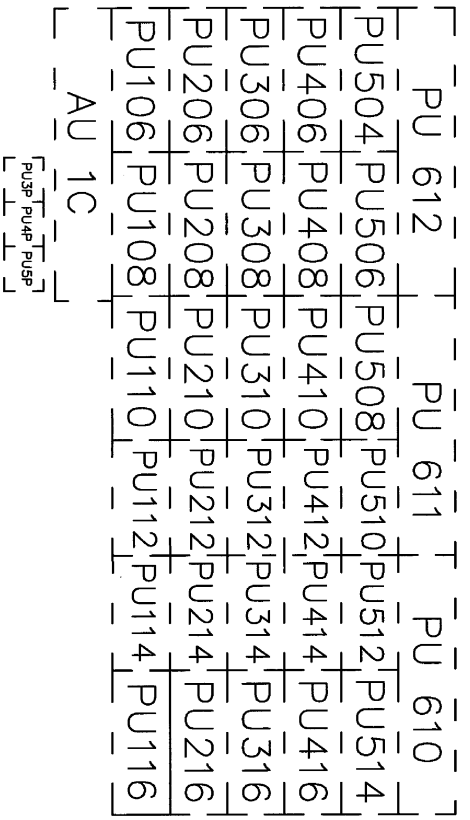

COMMON PROPERTY

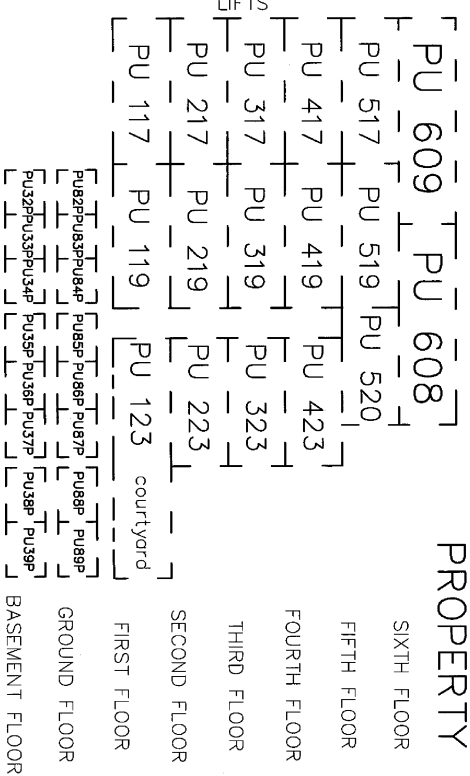

SHEET 11/12

LAND DISTRICT NORTH AUCKLAND
 DATASET TYPE SURVEYED
 DATUM GEODETIC 2000

PROPOSED UNIT DEVELOPMENT
 ON LOT 8 DP 480614

TERRITORIAL AUTHORITY Auckland Council
 Surveyed by HAMPSON & ASSOCIATES LTD
 Scale 1:200 Date October 2021

Comprised in 671991
 File 6479
 Received Instructions
 DP 538206/A

608
 COMMON
 PROPERTY

PU609
 PU516 PU518 520
 PU418 PU420 PU421
 PU318 PU320 PU321
 PU218 PU220 PU221
 PU118 PU120 PU121
 SIXTH FLOOR
 FIFTH FLOOR
 FOURTH FLOOR
 THIRD FLOOR
 SECOND FLOOR
 FIRST FLOOR
 GROUND FLOOR
 BASEMENT FLOOR

COMMON PROPERTY

SECTION F-F'

COMMON
 PROPERTY

PUE67P PUE68P PUE69P PU70P PU71P
 PU133P PU144P PU155P PUE67P PUE68P PUE69P
 PU177P PU188P PU199P PU200P PU211P

COMMON PROPERTY

SECTION E-E'

SHEET 12/12

COMMON
 PROPERTY

PU 607 PU 608
 PU 517 PU 519 PU 520
 PU 417 PU 419 PU 422
 PU 317 PU 319 PU 322
 PU 217 PU 219 PU 222
 PU 117 PU 119 PU 122 courtyard
 SIXTH FLOOR
 FIFTH FLOOR
 FOURTH FLOOR
 THIRD FLOOR
 SECOND FLOOR
 FIRST FLOOR
 GROUND FLOOR
 BASEMENT FLOOR

PU90P PU91P PU92P PU93P PU94P PU95P PU96P PU97P
 PU40P PU41P PU42P PU43P PU44P PU45P PU46P PU47P

LAND DISTRICT DATASET TYPE DATUM	NORTH AUCKLAND SURVEYED GEODETIC 2000	PROPOSED UNIT DEVELOPMENT ON LOT 8 DP 480614	TERRITORIAL AUTHORITY Auckland Council Surveved by HAMPSON & ASSOCIATES LTD Scale 1:200 Date October 2021	Comprised in 671991 File 6479 Received Instructions	DP 538206/A
--	---	---	---	---	-------------

Land Registration District

North Auckland

Plan Number

DP 538206/A

Territorial Authority (the Council)

Auckland

Schedule of Existing Easements in Gross			
Purpose	Shown	Servient Tenement (Burdened Land)	Document
Right to convey Electricity	A & V	Lot 8 DP 480614	12065872.1
Right to convey Telecommunications	A	Lot 8 DP 480614	12065872.2

Land Covenant in Easement Instrument 10053825.9

Land Covenant in Easement Instrument 10157293.2