

## **Crown Pastoral Land Tenure Review**

**Lease name : MESOPOTAMIA**

**Lease number : PT 057**

### **Fish & Game Report - Plans (2)**

These plans attach to and support the Fish and Game Report provided by Fish & Game NZ.

They are released under the Official Information Act 1982.

**September 05**



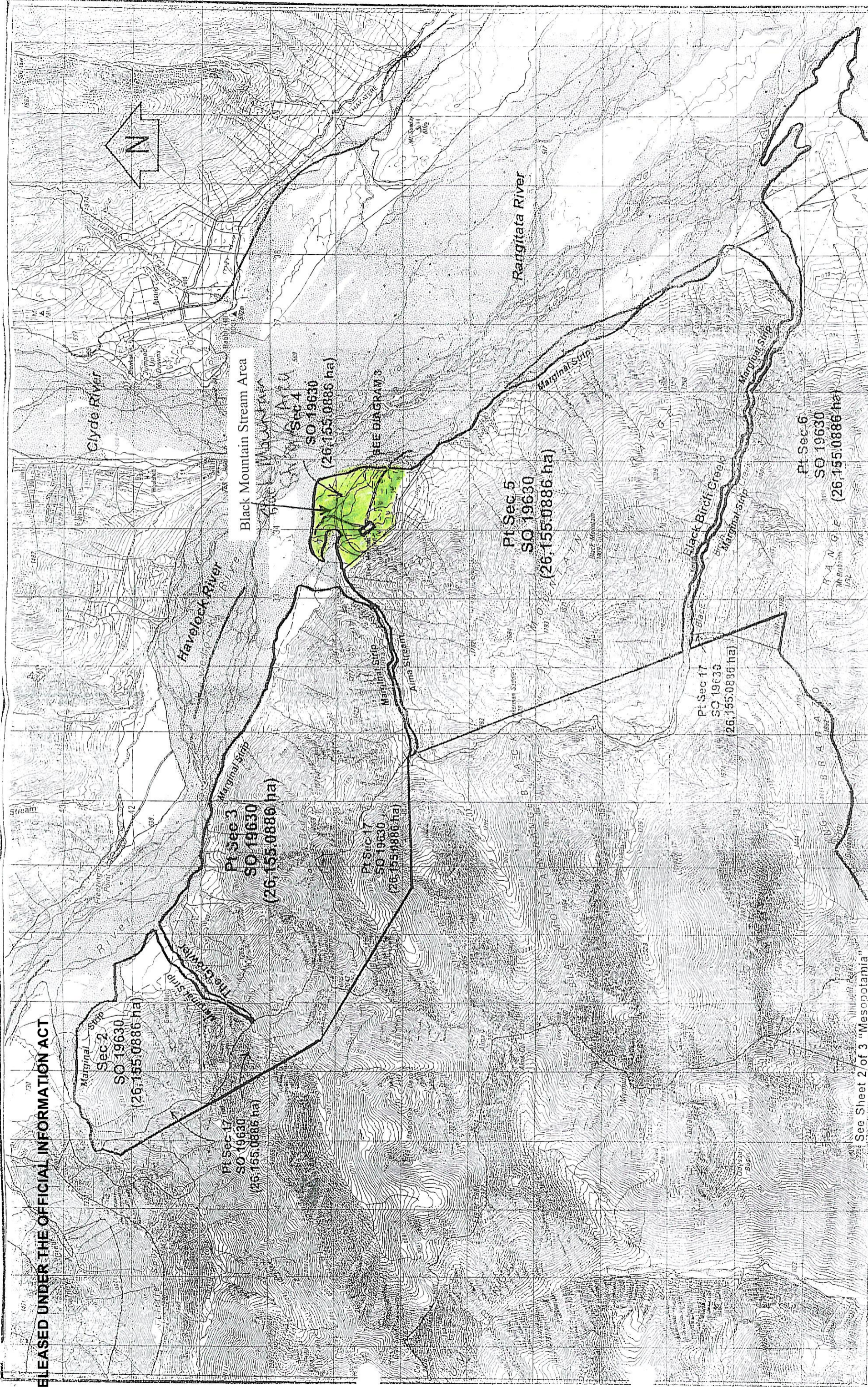

EXCLUDES ALL LEGAL ROADS AND MARGINAL STRIPS (IF ANY)

MESOPOTAMIA  
(Sections 2, 4, 8-13, 15 and 16 and Part Sections 3, 5-7, 14 and 17 SO 19630)

Version	1	2	3	4	5
Canterbury Land District					
NZMS 260 (35, 136, J35 & J36)					
Sheet 3 of 3					
Date 26/3/2001					

1:50,000

See Sheet 2 of 3 "Mesopotamia"