

## **Crown Pastoral Land Tenure Review**

**Lease name : MESOPOTAMIA**

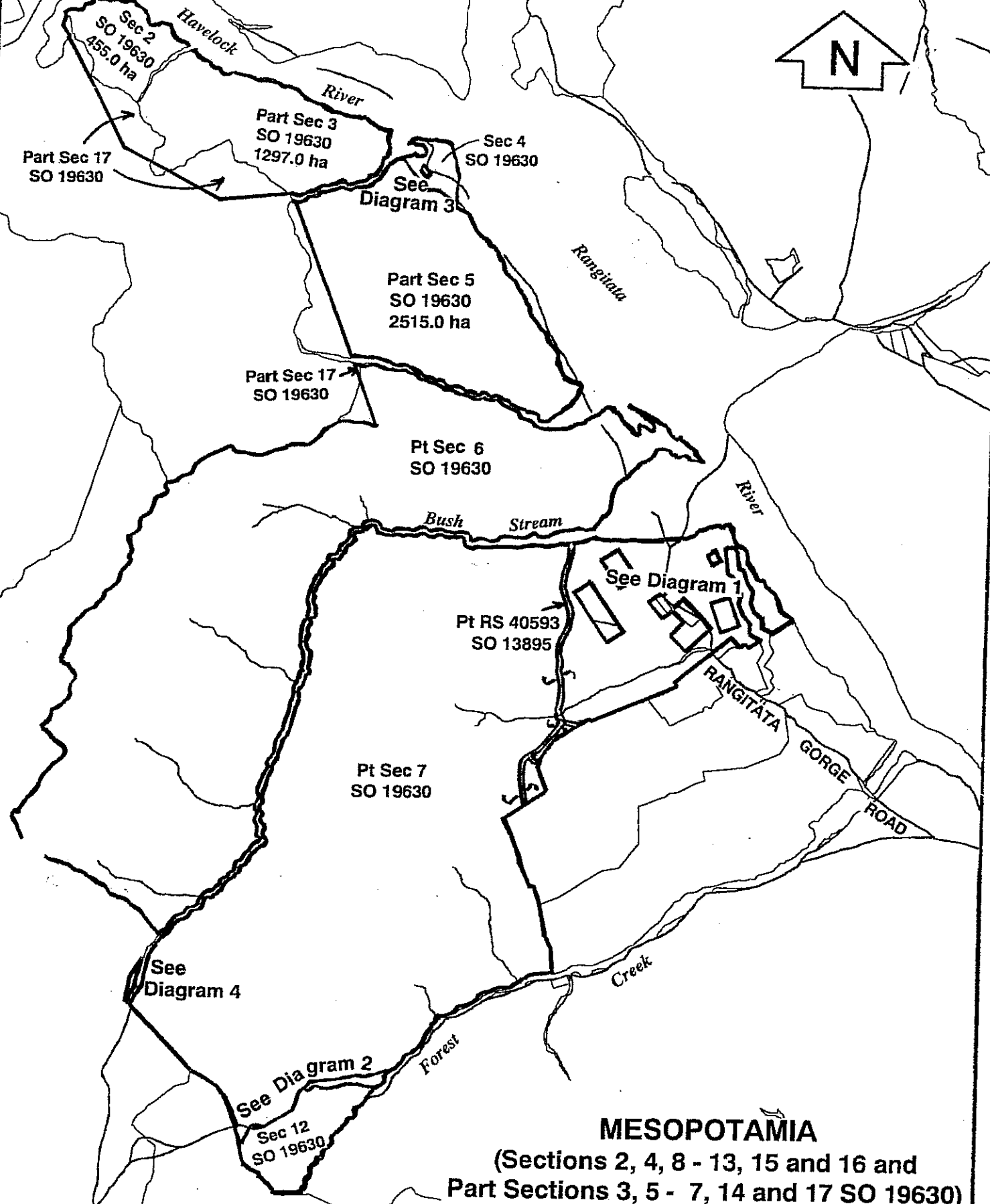
**Lease number : PT 057**

### **Due Diligence Report - Plans**

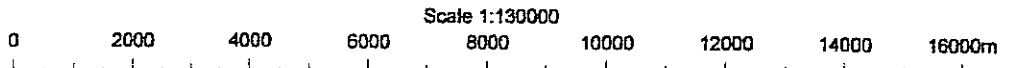
These plans attach to and support the Due Diligence Report.

They are released under the Official Information Act 1982.

September 05

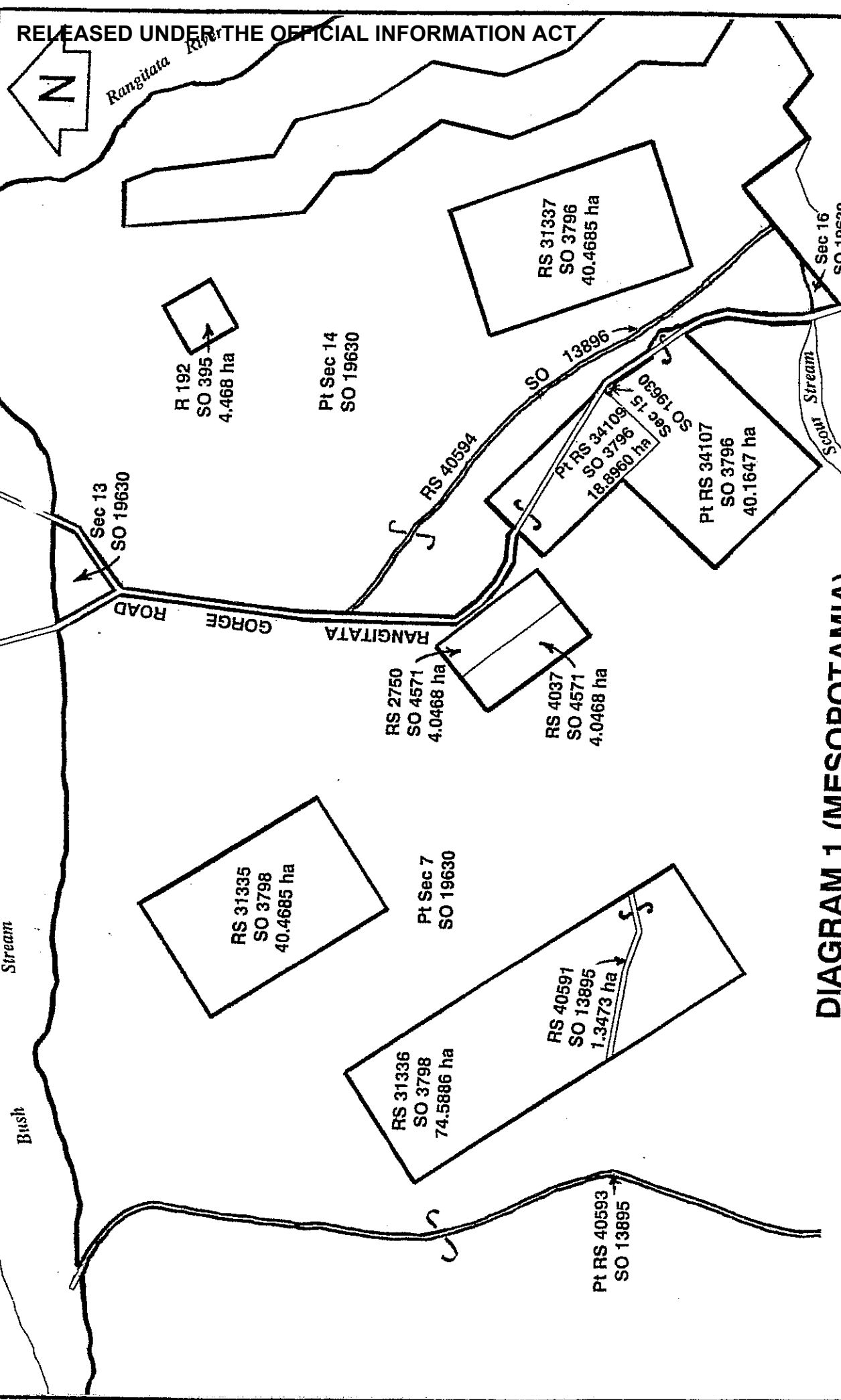


**MESOPOTAMIA**  
 (Sections 2, 4, 8 - 13, 15 and 16 and  
 Part Sections 3, 5 - 7, 14 and 17 SO 19630)



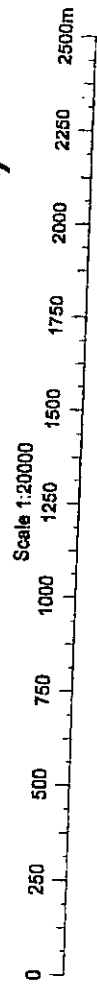
Interbury Land District  
 cadastral data correct  
 at 5/2/2001  
 Reference NZMS 260 - I35, I36, J35 & J36

Note: All legal roads and or marginal strips are excluded from pastoral run "Mesopotamia".

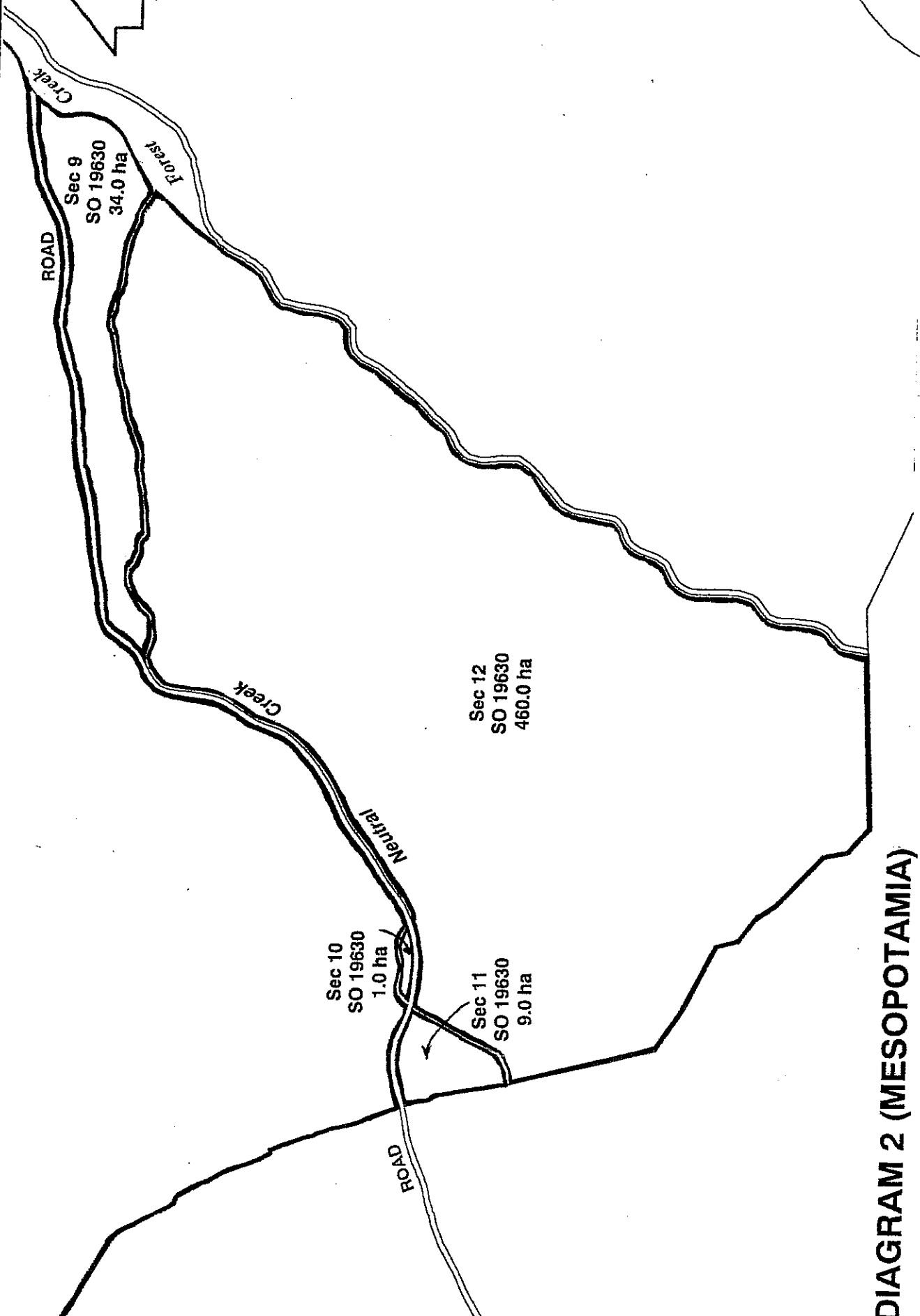


Canterbury Land District  
 Cadastral data correct  
 as at 5/2/2001  
 Reference NZMS 260 - J36

**DIAGRAM 1 (MESOPOTAMIA)**



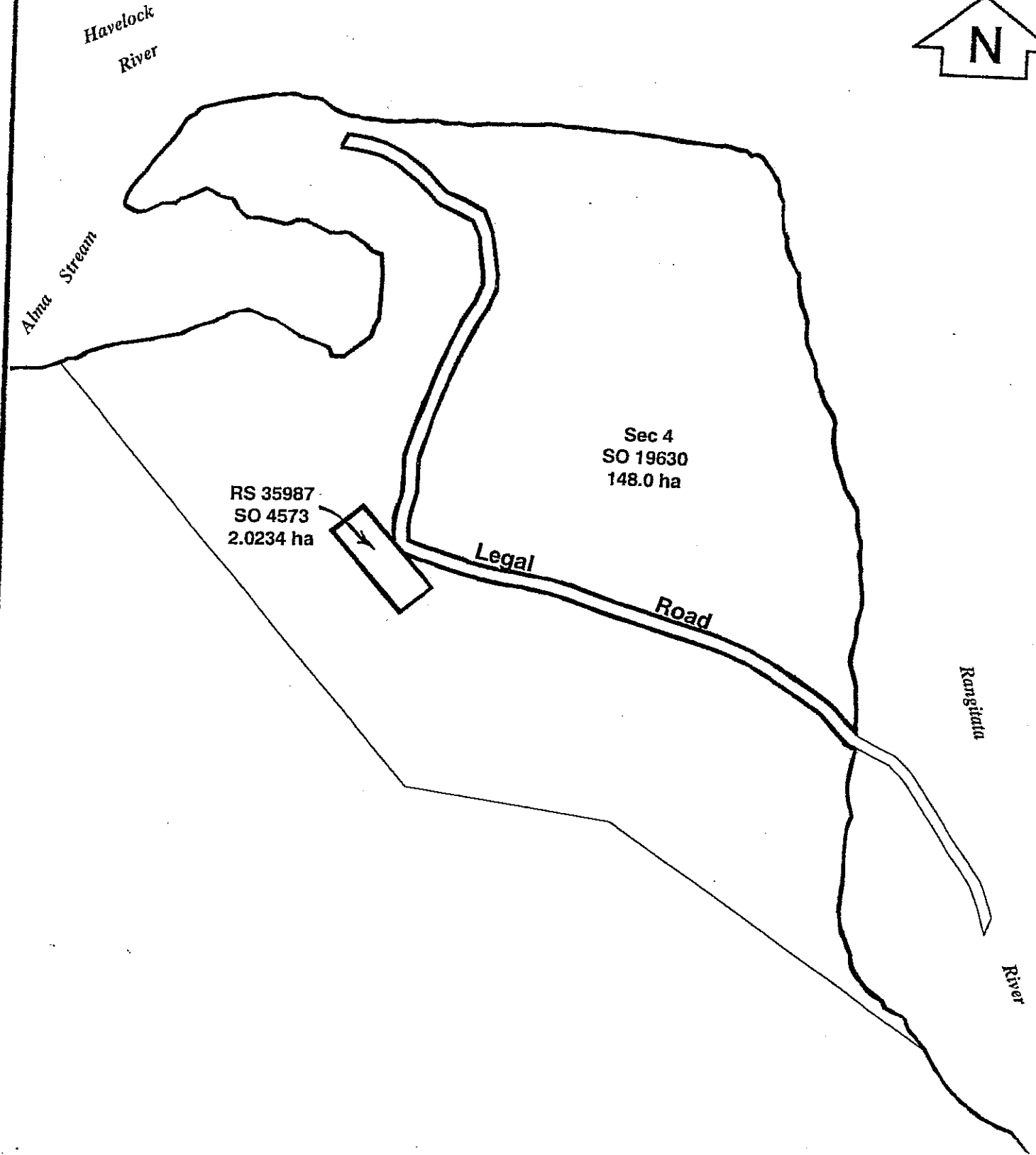
Note: All legal roads and or marginal strips are excluded from pastoral run "Mesopotamia".



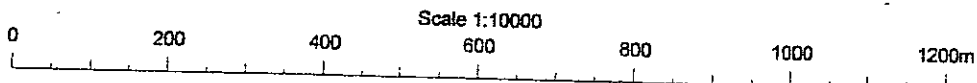
**DIAGRAM 2 (MESOPOTAMIA)**

Note: All legal roads and or marginal strips are excluded from pastoral run "Mesopotamia".

Canterbury Land District  
Cadastral data correct  
as at 5/2/2001  
Reference NZMS 260 - 136

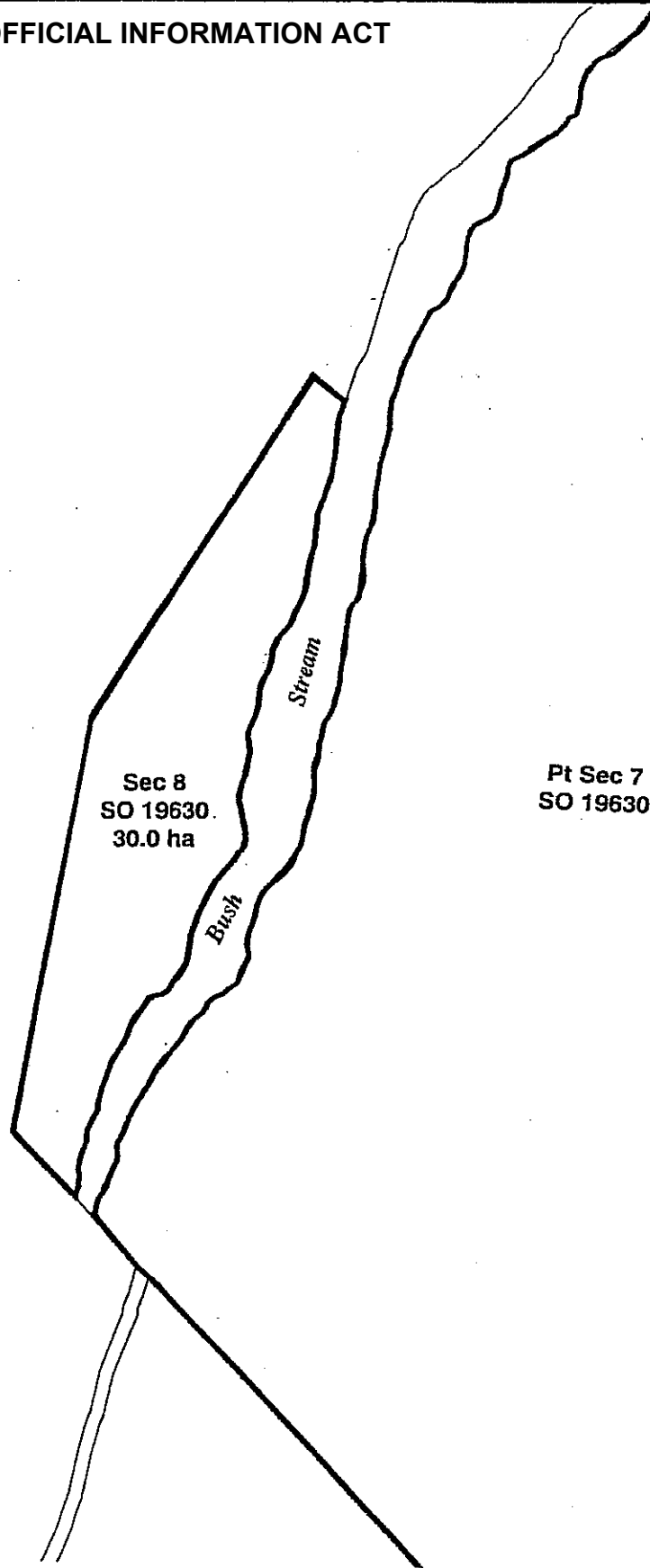


**DIAGRAM 3 (MESOPOTAMIA)**

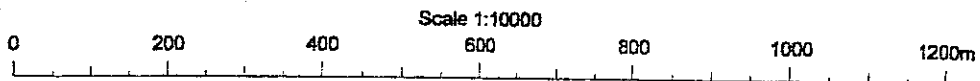


Canterbury Land District  
Cadastral data correct  
as at 5/2/2001  
Reference NZMS 260 - 136

Note: All legal roads and or marginal strips are  
excluded from pastoral run "Mesopotamia".



**DIAGRAM 4 (MESOPOTAMIA)**



Canterbury Land District  
Cadastral data correct  
as at 5/2/2001  
Reference NZMS 260 - 136

Note: All legal roads and or marginal strips are excluded from pastoral run "Mesopotamia".

See Sheet 2 of 3 "Mesopotamia"

Pt Sec 6  
SO 19630  
(26,155.0886 ha)

Pt Sec 7  
SO 19630  
(26,155.0886 ha)

Sec 8  
SO 19630  
(26,155.0886 ha)

SEE DIAGRAM 4

Sec 9  
SO 19630  
(26,155.0886 ha)

SEE DIAGRAM 2

Sec 10  
SO 19630  
(26,155.0886 ha)

Sec 12  
SO 19630  
(26,155.0886 ha)

Sec 11  
SO 19630  
(26,155.0886 ha)



Forest Creek

Marginal Strip

Marginal Strip

Marginal Strip

Marginal Strip

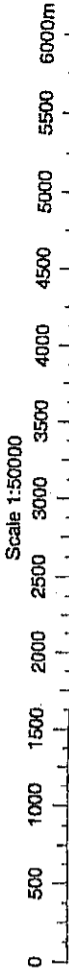
Bush Stream

Marginal Strip

Marginal Strip

Marginal Strip

Marginal Strip



For full definition of marginal strips  
(sec 24(3) Conservation Act 1987)  
see SO 19630

Note: All legal roads and or marginal strips  
are excluded from pastoral run "Mesopotamia"

**MESOPOTAMIA (SHEET 1 OF 3)**  
**(Sections 2,4,8-13, 15 and 16 and**  
**Part Sections 3,5-7, 14 and 17 SO 19630)**

Canterbury Land District  
Cadastral data correct  
as at 26/03/2001  
Reference NZMS 260 - 135,136, J35, and J36

See Sheet 3 of 3 "Mesopotamia"

Pt Sec 5  
SO 19630  
(26,155.0886 ha)

Sec 13  
SO 19630  
(26,155.0886 ha)

Pt Sec 6  
SO 19630  
(26,155.0886 ha)

Pt Sec 7  
SO 19630  
(26,155.0886 ha)

Pt Sec 14  
SO 19630  
(26,155.0886 ha)  
SEE DIAGRAM 1

Sec 15  
SO 19630  
(26,155.0886 ha)

Sec 16  
SO 19630  
(26,155.0886 ha)



Rangitata River

RANGITATA GORGE ROAD

Marginal Strip

Marginal Strip

Bush Stream

Marginal Strip

Bush Stream

Marginal Strip

Marginal Strip

Marginal Strip

Scour Stream  
Marginal Strip

For full definition of marginal strips  
(sec 24(3) Conservation Act 1987)  
see SO 19630

Note: All legal roads and or marginal strips  
are excluded from pastoral run "Mesopotamia"

See Sheet 1 of 3 "Mesopotamia"

**MESOPOTAMIA (SHEET 2 OF 3)**  
(Sections 2,4,8-13, 15 and 16 and  
Part Sections 3,5-7, 14 and 17 SO 19630)

Canterbury Land District  
Cadastral data correct  
as at 26/03/2001  
Reference NZMS 260 - I35,I36,J35 and J36

1:50,000





Clyde River

Havelock River

Rangitata River

Marginal Strip  
Sec 2  
SO 19630  
(26,155.0886 ha)

Pt Sec 17  
SO 19630  
(26,155.0886 ha)

Marginal Strip  
Pt Sec 3  
SO 19630  
(26,155.0886 ha)

Marginal Strip  
Pt Sec 17  
SO 19630  
(26,155.0886 ha)

Sec 4  
SO 19630  
(26,155.0886 ha)

SEE DIAGRAM 3

Pt Sec 5  
SO 19630  
(26,155.0886 ha)

Pt Sec 17  
SO 19630  
(26,155.0886 ha)

Pt Sec 6  
SO 19630  
(26,155.0886 ha)

Marginal Strip  
The Growler

Marginal Strip  
Alma Stream

Marginal Strip

Marginal Strip  
Black Birch Creek

Marginal Strip

See Sheet 2 of 3 "Mesopotamia"

For full definition of marginal strips  
(sec 24(3) Conservation Act 1987)  
see SO 19630

Note: All legal roads and or marginal strips  
are excluded from pastoral run "Mesopotamia"

**MESOPOTAMIA (SHEET 3 OF 3)**  
(Sections 2,4,8-13, 15 and 16 and  
Part Sections 3,5-7, 14 and 17 SO 19630)

1:50,000

See Sheet 2 of 3 "Mesopotamia"

Pt Sec 5  
SO 19630  
(26,155.0886 ha)

Pt Sec 7  
SO 19630  
(26,155.0886 ha)

Sec 8  
SO 19630  
(26,155.0886 ha)

SEE DIAGRAM 4

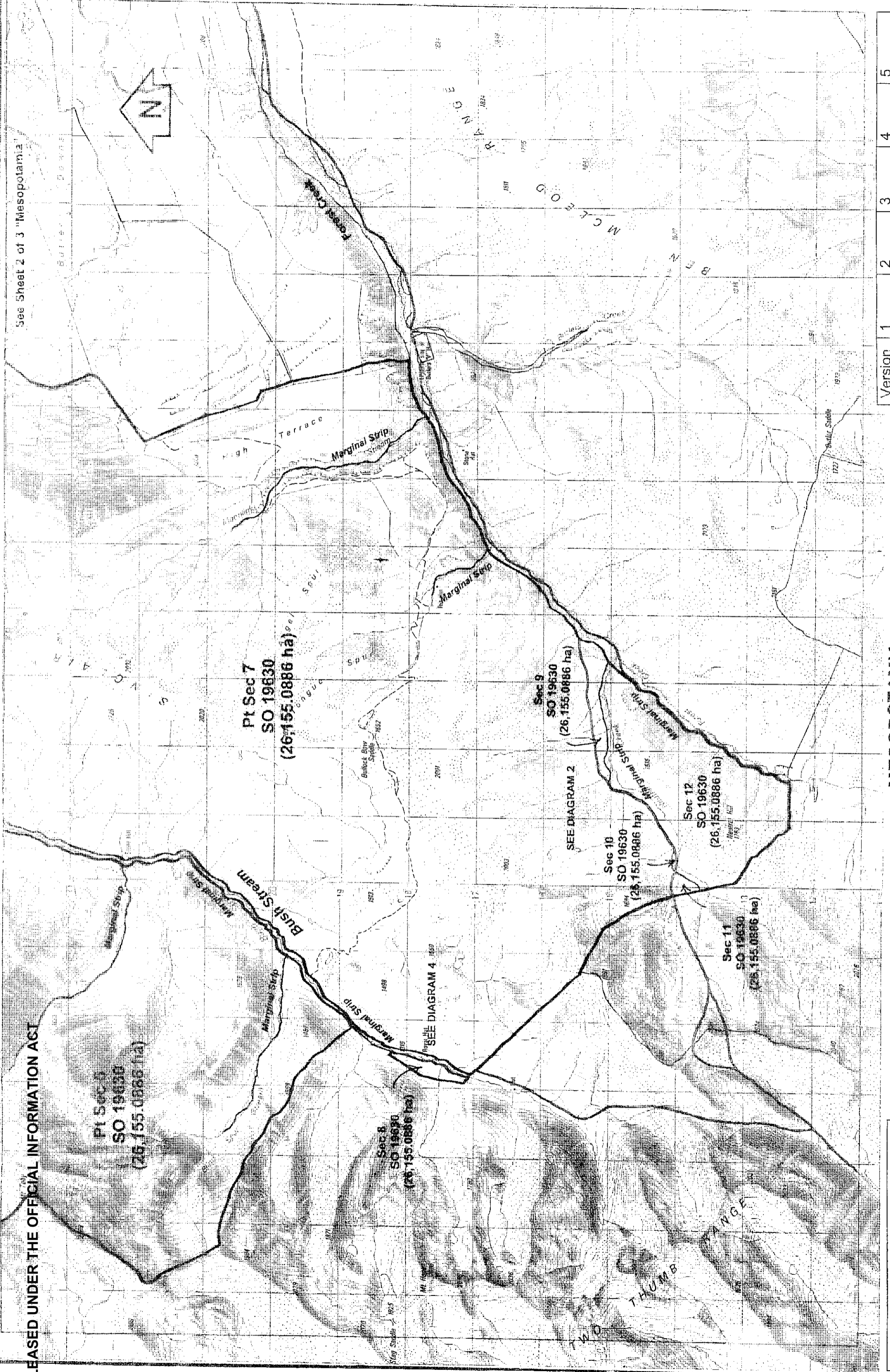
Sec 9  
SO 19630  
(26,155.0886 ha)

SEE DIAGRAM 2

Sec 10  
SO 19630  
(26,155.0886 ha)

Sec 12  
SO 19630  
(26,155.0886 ha)

Sec 11  
SO 19630  
(26,155.0886 ha)

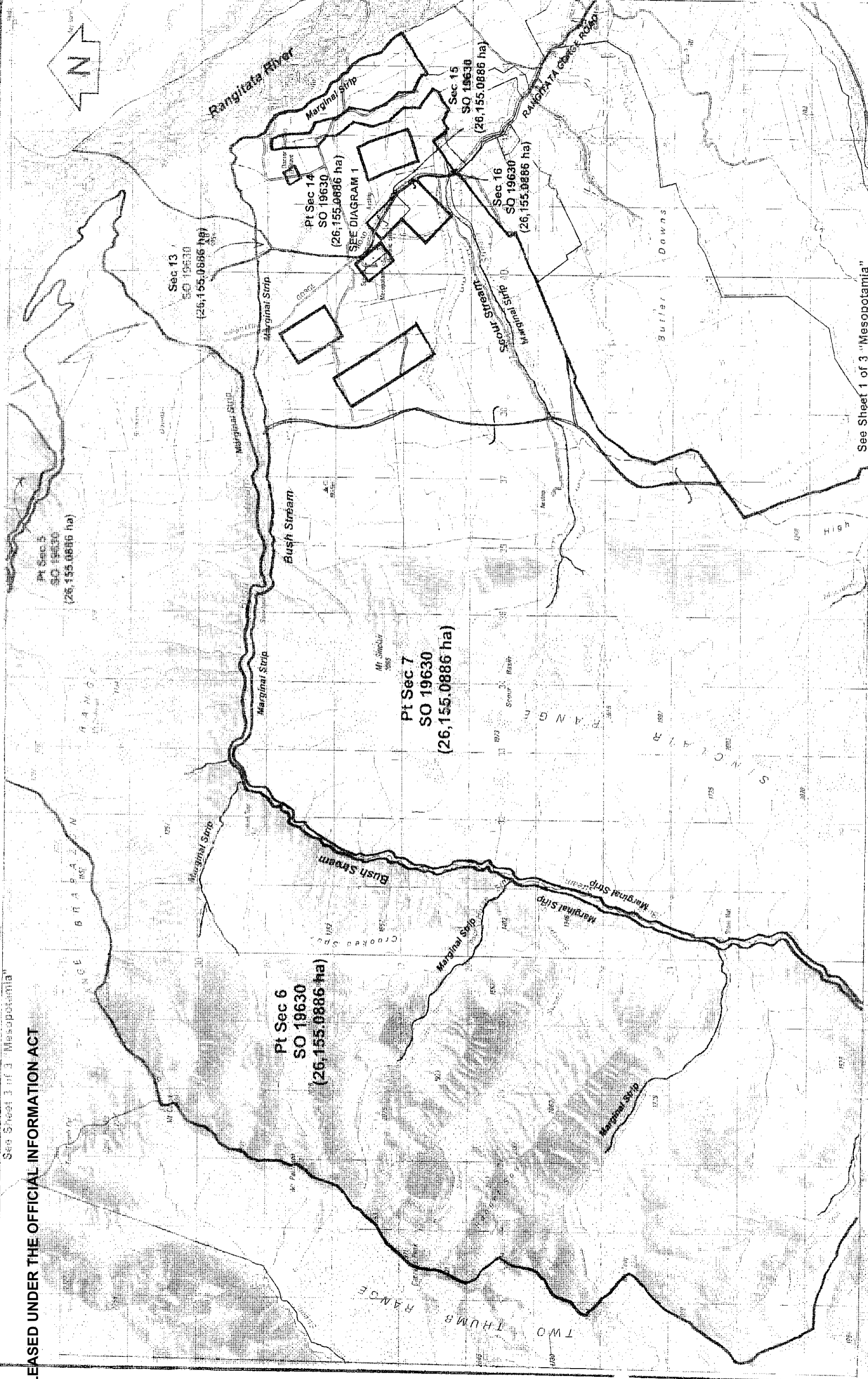


EXCLUDES ALL LEGAL ROADS  
AND MARGINAL STRIPS (IF ANY)

MESOPOTAMIA  
(Sections 2,4,8-13, 15 and 16 and Part Sections 3,5-7, 14 and 17 SO 19630)

Version	1	2	3	4	5
Canterbury Land District					
NZMS 260 135, 136, J35 & J36					
Sheet 1 of 3					
Date 26/3/2001					

RELEASED UNDER THE OFFICIAL INFORMATION ACT



See Sheet 1 of 3 "Mesopotamia"

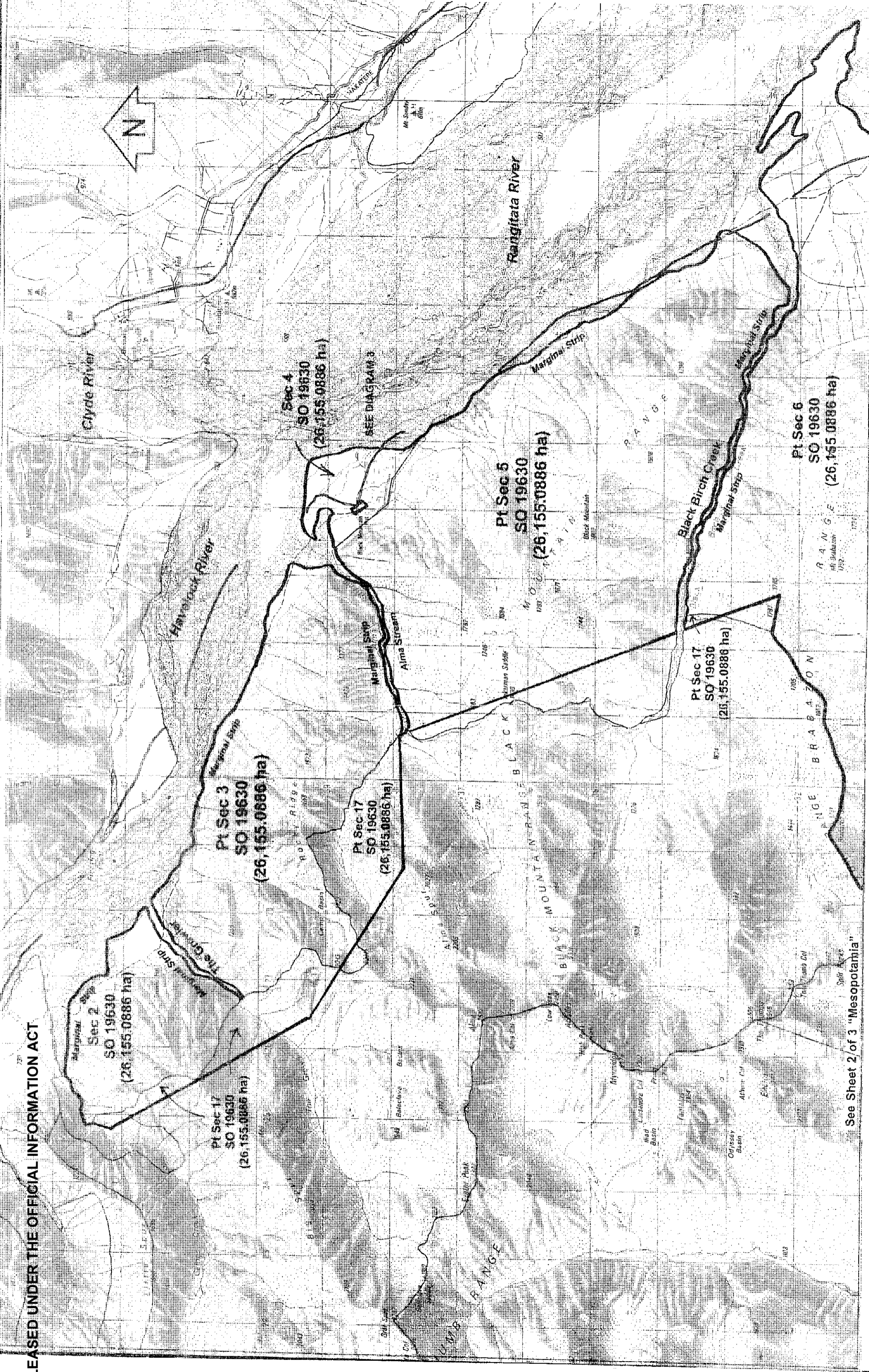
EXCLUDES ALL LEGAL ROADS AND MARGINAL STRIPS (IF ANY)

MESOPOTAMIA  
(Sections 2,4,8-13, 15 and 16 and Part Sections 3,5-7, 14 and 17 SO 19630)

Version	1	2	3	4	5
Canterbury Land District					
NZMS	260	135, 136, J35 & J36			
Date	26/3/2001				

1:50,000





See Sheet 2 of 3 "Mesopotamia"

EXCLUDES ALL LEGAL ROADS  
AND MARGINAL STRIPS (IF ANY)

**MESOPOTAMIA**  
(Sections 2,4,8-13, 15 and 16 and Part Sections 3,5-7, 14 and 17 SO 19630)  
1:50,000

Version	1	2	3	4	5
Canterbury Land District					
NZMS 260 135, 136, J35 & J36					
Sheet 3 of 3					
Date 26/3/2001					