



Record of Survey - LT 599165

Survey Number LT 599165
Surveyor Reference 7188
Surveyor John Bailey Hunt
Survey Firm Thornley & Associates Ltd
Surveyor Declaration I John Bailey Hunt, being a licensed cadastral surveyor, certify that--
 (a) this dataset provided by me and its related survey are accurate, correct and in accordance with the Cadastral Survey Act 2002 and Cadastral Survey Rules 2021; and
 (b) the survey was undertaken by me or under my personal direction.
 Declared on 18 Jun 2024 02:38 PM

Survey Details

Dataset Description	Units on Lot 13 DP 19432		
Purpose	Standard Unit Plan		
Status	Approved as to Survey	Type	Survey
Land District	North Auckland	Survey Class	Class A
Meridional Circuit	Mount Eden 2000	Vertical Datum	None

Survey Dates

Surveyed Date	28/11/2023	Certified Date	18/06/2024
Submitted Date	18/06/2024 14:38:03	Survey Approval Date	19/06/2024
Deposit Date			

Referenced Surveys

Survey Number	Land District	Bearing Correction
DP 19432	North Auckland	0°00'00"
DP 42885	North Auckland	0°00'00"
DP 390348	North Auckland	0°00'00"

Territorial Authorities

Auckland Council

Comprised In

RT NA474/205

Created Parcels

Parcels	Parcel Intent	Area	RT Reference
Principal Unit 1 Deposited Plan 599165	Principal Unit		1164209
Principal Unit 2 Deposited Plan 599165	Principal Unit		1164210
Accessory Unit 2A Deposited Plan 599165	Accessory Unit		
Accessory Unit 2B Deposited Plan 599165	Accessory Unit		
Accessory Unit 1A Deposited Plan 599165	Accessory Unit		
Total Area		0.0000 Ha	

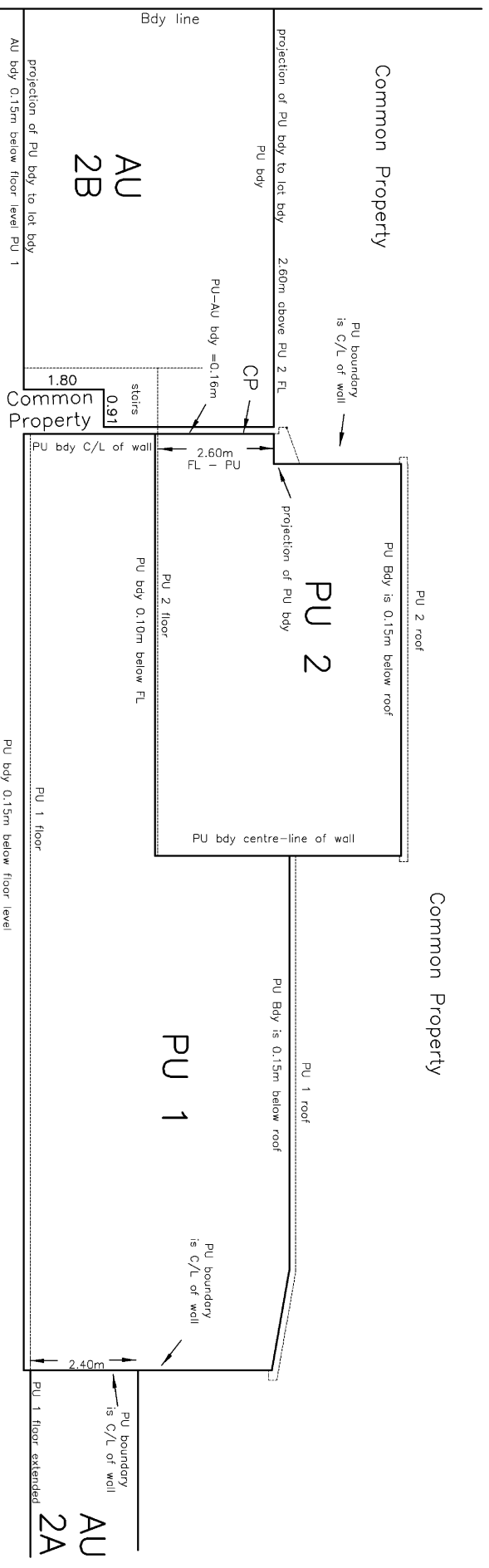

Cross-section X' - X
Scale H = 1:100 @A3

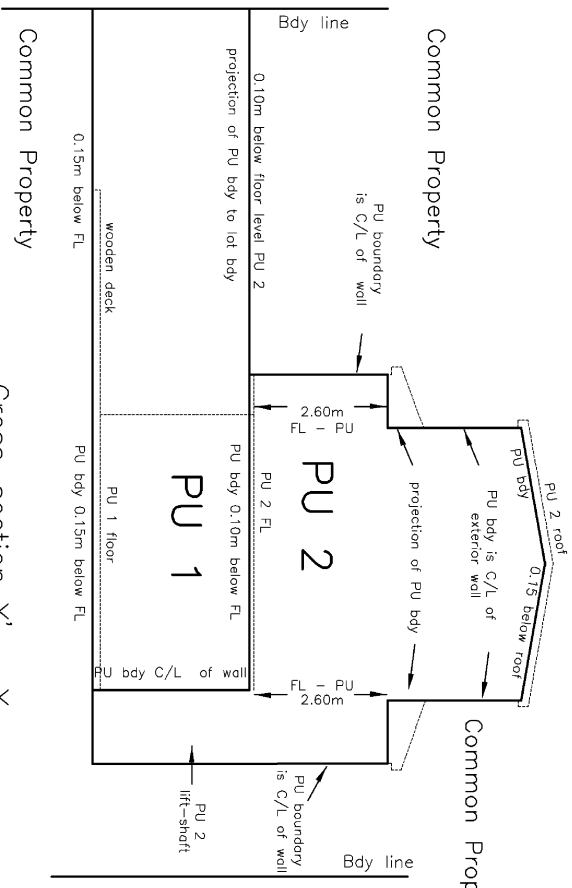

Cross-section Y' - Y
Scale H = 1:100 @A3

- Notes
1. PU boundaries are the centre of walls, floors glazing and doors and extensions/ projections thereof unless shown otherwise
 2. Unless shown otherwise Common Property and AU boundaries coincide with Legal Boundary
 3. PU = Principal Unit; AU = Accessory Unit
 4. CP = Common Property; C/L = centre-line of structure; FL = top of floor level; roof = exterior face of roof
 5. Upper limit of Common Property containing pillars is intersection with PU 2 boundary
 6. Boundary dimensions adopted from DP 19432

DP 42885
1

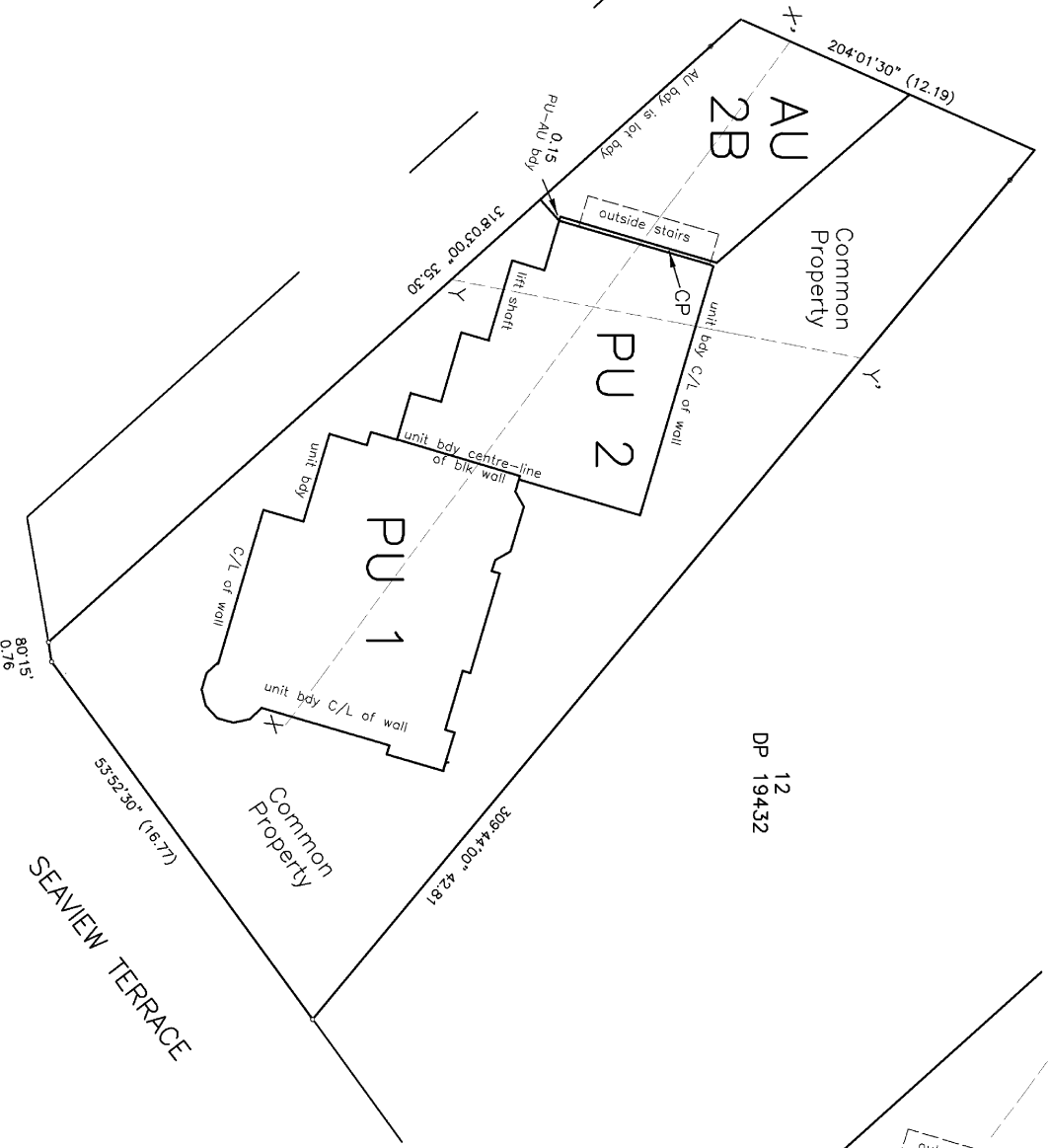

DP 19432
12

Layout at Upper Level

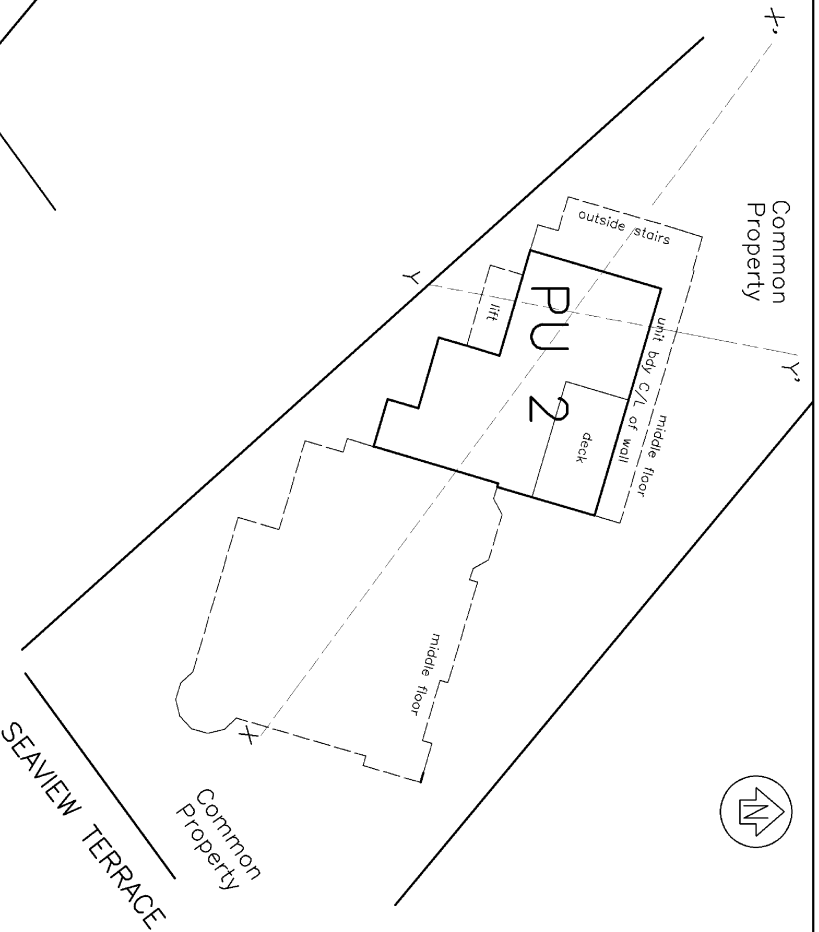

Notes

1. PU boundaries are the centre of walls, floors glazing and doors and extensions/ projections thereof unless shown otherwise
2. Unless shown otherwise Common Property and AU boundaries coincide with Legal Boundary
3. PU = Principal Unit; AU = Accessory Unit
4. CP = Common Property; C/L = centre-line of structure; FL = top of floor level; roof = exterior face of roof
5. Upper limit of Common Property containing pillars is intersection with PU 2 boundary
6. Boundary dimensions adopted from DP 19432

Sheet 2 of 3

Layout at Middle Level

LAND DISTRICT North Auckland

Plan of Units on Lot 13 DP 19432

TERRITORIAL AUTHORITY Auckland Council
Surveyed by Thornley & Associates Ltd
Scale 1:200 Date June 2023

Comprised in NA474/205
File 7188
Supervisor Class of Survey A

DP 599165

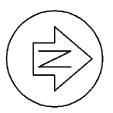

DP 42885

DP 19432

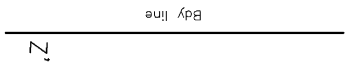
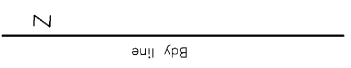
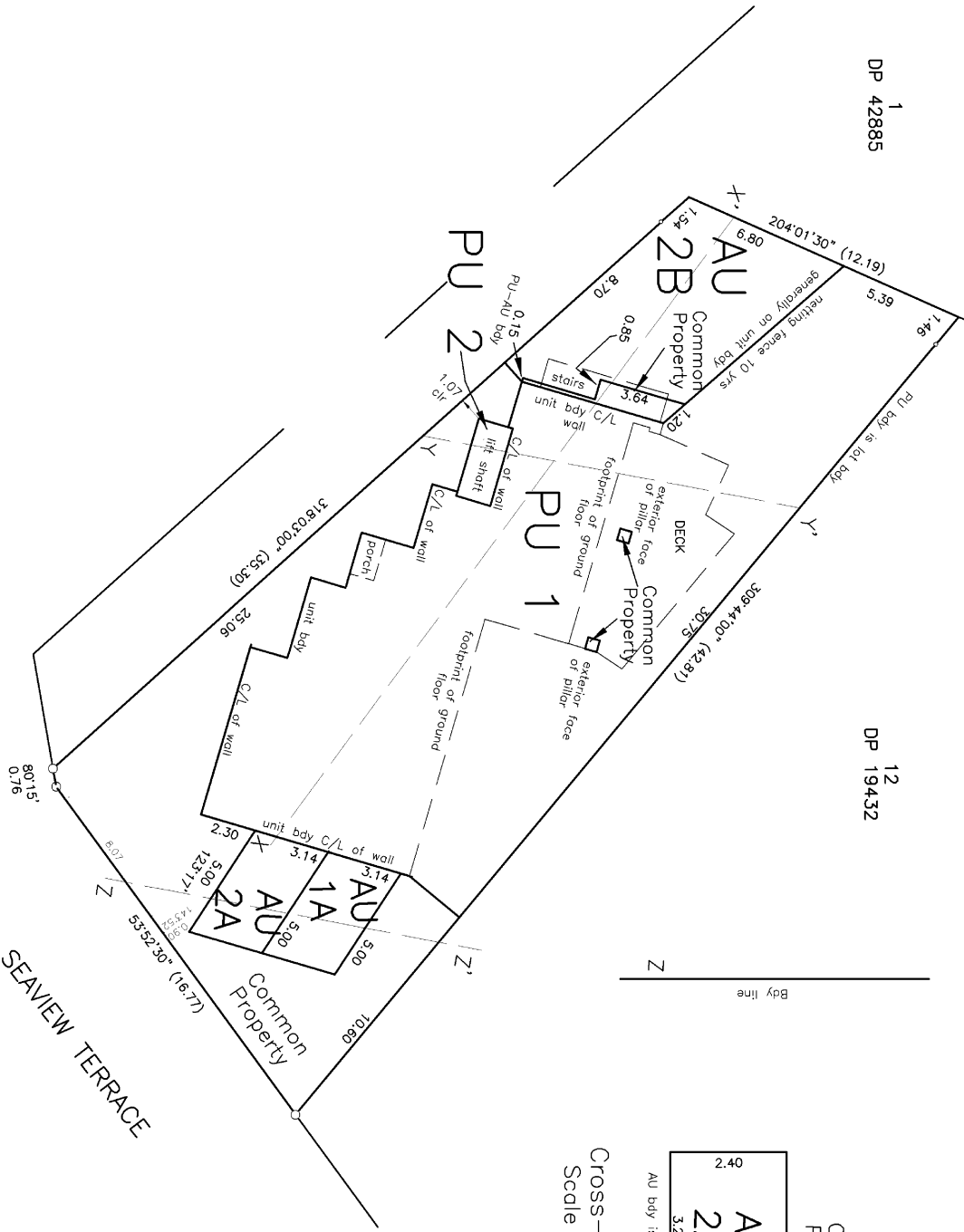

Cross-section Z - Z'
Scale H = 1:100 @A3

Notes

1. PU boundaries are the centre of walls, floors glazing and doors and extensions/ projections thereof unless shown otherwise
2. Unless shown otherwise Common Property and AU boundaries coincide with Legal Boundary
3. PU = Principal Unit; AU = Accessory Unit
4. CP = Common Property; C/L = centre-line of structure; FL=top of floor level; roof= exterior face of roof
5. Upper limit of Common Property containing pillars is intersection with PU 2 boundary
6. Boundary dimensions adopted from DP 19432

Layout at Ground Level

Plan of Units on Lot 13 DP 19432

LAND DISTRICT North Auckland

TERRITORIAL AUTHORITY Auckland Council
Surveyed by Thornley & Associates Ltd
Scale 1:200 Date June 2023

Comprised in NA474/205 559m²
File 7188
Class of Survey A
DP 599165